

- Ondatra zibethica, evidence of used runway channels.
- Butorides virescens virescens 1 bird on west side
- Bataurus lentiginosus 1 bird on west side
- Shobrychus spilis spilis 1 bird on west side
- Erallia pusillus 5 birds

Area ② along Kaw River course disclosed 42 Anas discors resting on mud bank on n. side river. Actitis macularia along river edge. River shows considerable evidence of lateral erosion with large live cottonwood tree dislodged from the edge. At point ④ found a tree (8" in diameter) felled by beaver (Castor canadensis) of early <sup>or middle</sup> summer period. Dry leaves still on branches. No evidence of shoe buds on mud flat on along river course.

Area ③ almost completely overgrown with aquatic vegetation. Approx 80 Anas discors and 38 Fulvia americana in this area. No heron along entire east side water-land contact. Frog numerous in all areas examined. One Rana catesbeiana at S. end of pond area no ①

Museum of Natural History, Univ. of Kansas, Douglas Co., Kansas.

Oct 4, 1950

Chaetura pelagica still in area on Campus but is slightly decreased numbers. Night watchman at K.U. reports the Great Horned Owl at Frazer and Blake Building but not at Museum building. They (?) have been seen all summer on the campus. I suggest a condition in which these 2 birds are using area away from their nesting building (see previous notes) but still close by, at least they do not make themselves known in their nesting territory. Greatest congregation of Red wing blackbirds to date. They appear very restless as if it were the prelude to southern movements. Practically every tree from 13<sup>th</sup> to 23<sup>rd</sup> on the south end of town had hundreds of birds with continual calling along the entire course. These flocks have been gathering for about a month.

Oct 5, 1950

First day <sup>that</sup> I did not see Chaetura pelagica in the air and probably day of their departure. Lake Wabounee, Wabounee Co., 1,200 <sup>approx.</sup> feet, Kansas.

Oct 7, 1950

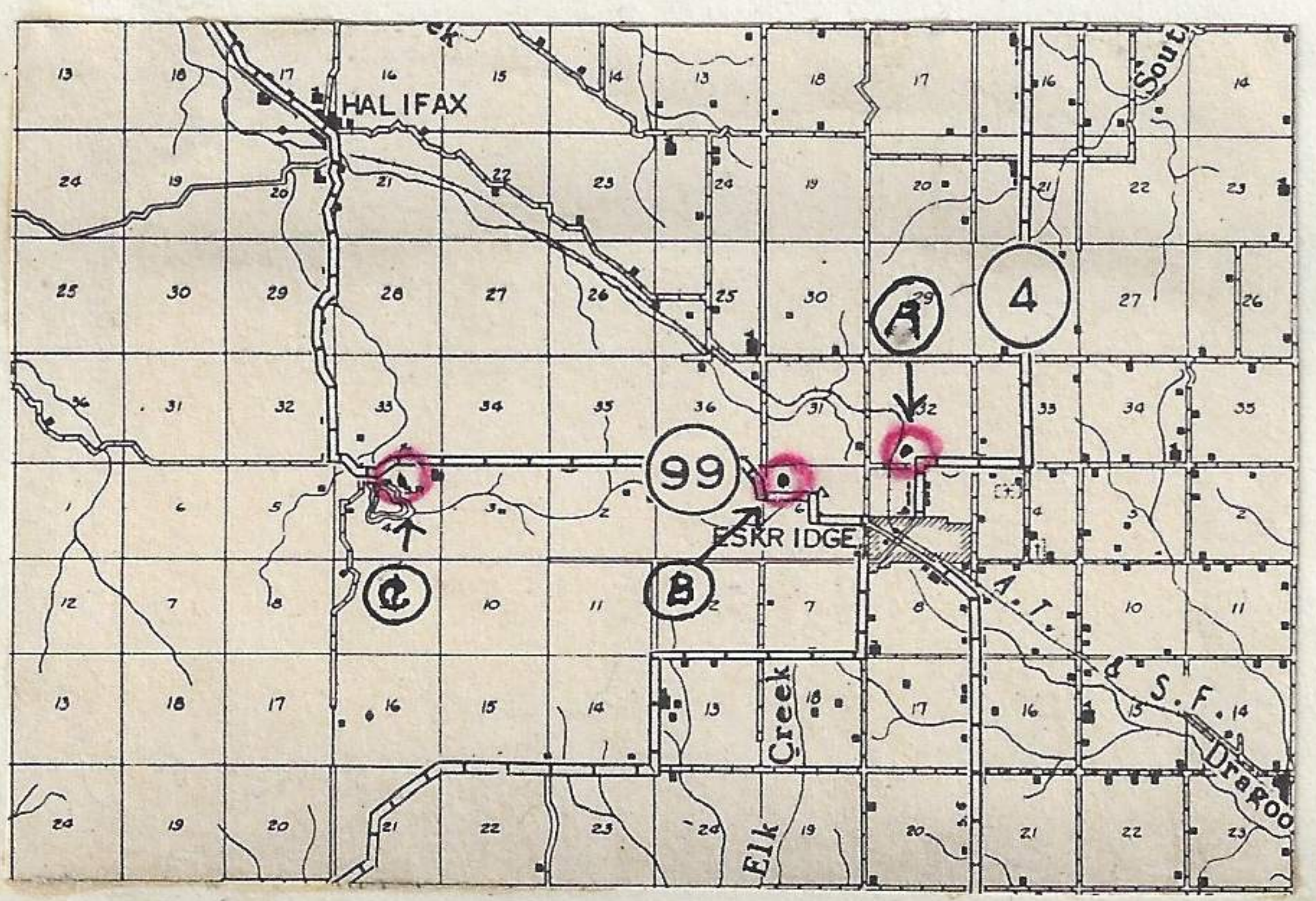

Continued Microtus ochrogaster transect (see notes of 4 Sept., 1950) by establishing three research areas as follows: 501007-A at 3/4 mi. N. Eskridge, 1409 feet, Wabounee Co., Kansas; research area 501007-B at 1 mi W and 1/2 mi. N Eskridge (P.O.), approx. 1485 ft., Wabounee Co., Kansas and research area 501007-C at Wabounee Lake, approx 1200 ft., Wabounee Co., Kansas