

3/4 mi. S and 3/4 mi. W Lawrence (P.O), Douglas County, Kansas 510330-5  
 March 29, 1951

Established research area 510330-1 in field 1/2 block west of site of new K.U. field house. Essentially open field of last year cut alfalfa. Stream course with running water. Runway confined to water course except upper S.W. corner where old weed and grass field has been allowed to grow wild. Set 26 traps at 4:30 P.M. and reexamined at 5:00 P.M. From line collected following at 5:00 P.M.

- trap 2. *Sigmodon hispidus* 510330-2
- trap 10. " " 510330-3
- trap 14. *Microtus ochrogaster* 510330-4

Grackles in area. Rabbits feeding in field in small groups and individuals.

March 31, 1951

Inspected research area 510330-1 at 8:30 A.M. and collected the following:

- trap 1. *Peromyscus maniculatus* 510331-1
- 2. *Bartzone*
- 3. sp.
- 4. *Peromyscus leucopus* 510331-2
- 6. " *maniculatus* 510331-3
- 7. " *leucopus* 510331-4
- 9. *Microtus ochrogaster* 510331-5
- 10. *Sigmodon hispidus* 510331-6
- 11. sp.
- 13. *Microtus ochrogaster* 510331-7
- 14. " " 510331-8
- 15. " " 510331-9
- 16. sp.
- 18. *Mus musculus* 510331-10
- 19. *Sigmodon hispidus* 510331-11
- 20. sp.
- 21. *Peromyscus leucopus* 510331-12
- 22. sp.
- 23. *Sigmodon hispidus* 510331-13
- 24. sp.
- 25. *Bartzone*

In the afternoon checked research area 510330-1 as follows:

- 2. *Sigmodon hispidus* 510330-14
- 3. sprung
- 7. sprung
- 9. sprung
- 12. *Sigmodon hispidus* 510330-15
- 13. *Mus. musculus* 510331-16
- 14. sp.
- 15. *Sigmodon hispidus* 510331-17
- 17. *Sigmodon hispidus* 510331-18
- 18. sp.
- 21. *Sigmodon hispidus* 510331-19
- 23. sp.
- 26. *Sigmodon hispidus* 510331-20

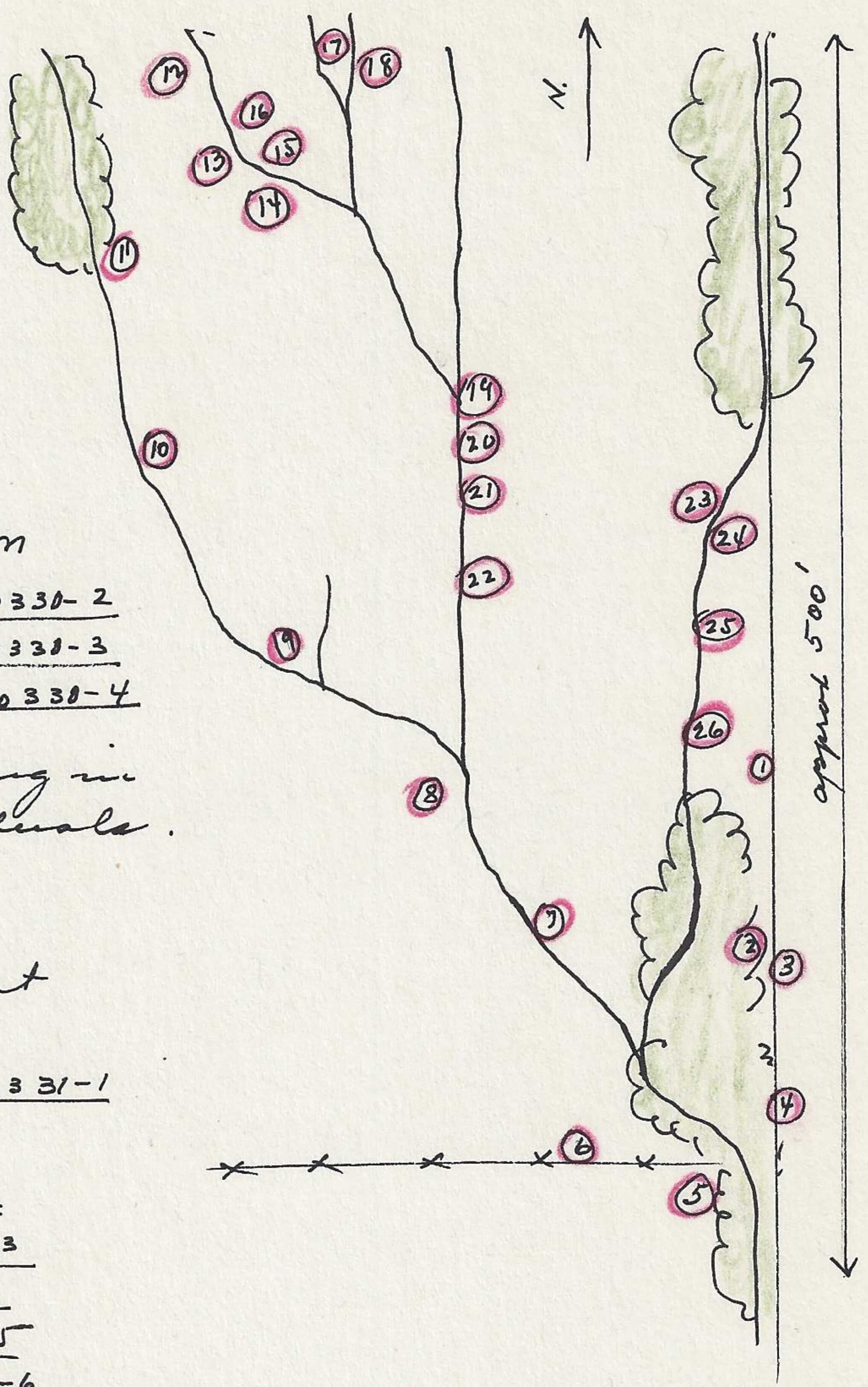

Site K.U. Field House