

labels for skins, 4 rolls cotton, 1 bat net, 2 bags saw dust for skinning, 1 box journal paper and Alaska mops.

Univ. Kansas Campus, Lawrence, Kansas

April 6, 1952

at 213 Sunnyside (Univ Housing) located nest of *Sylvilagus floridana* of three young each approx. 1300 mm in total length. The nest was 5 1/2 inches deep & 4 1/4 inches wide and excavated into soil.

The nest had been in use for 5 or 6 days but the adult was never seen in

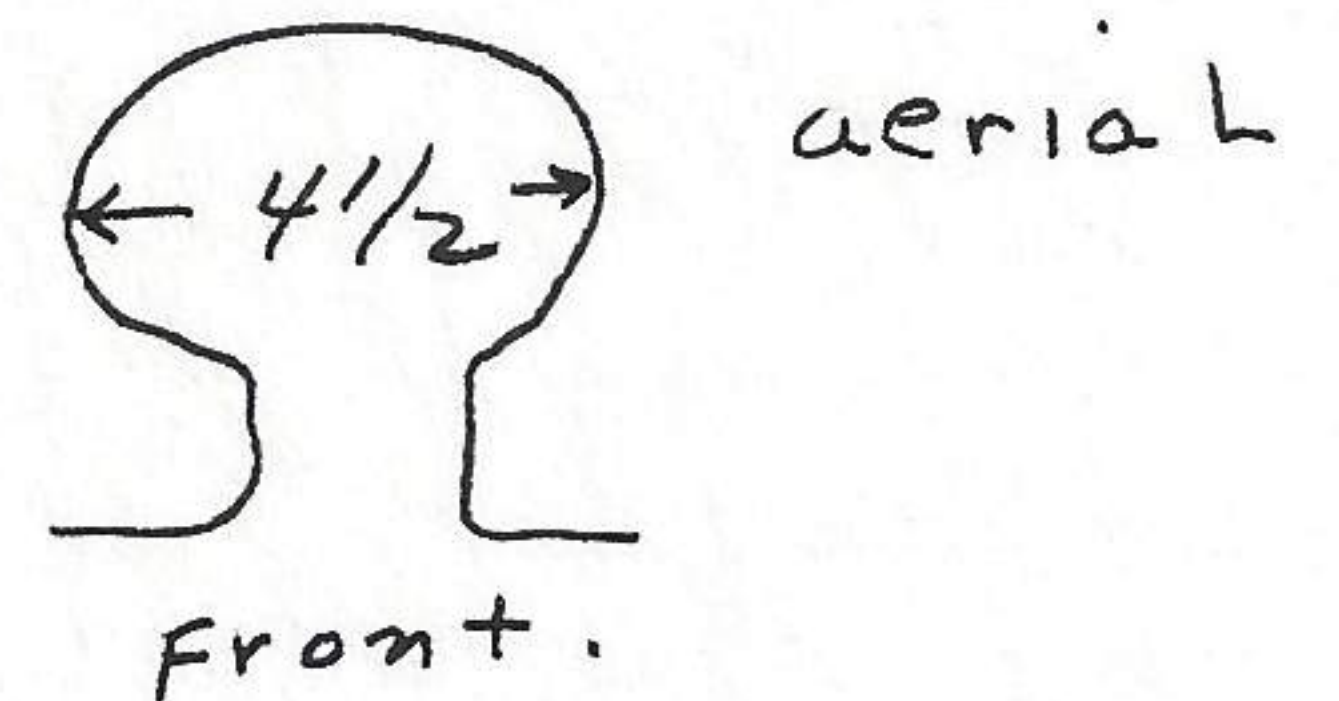
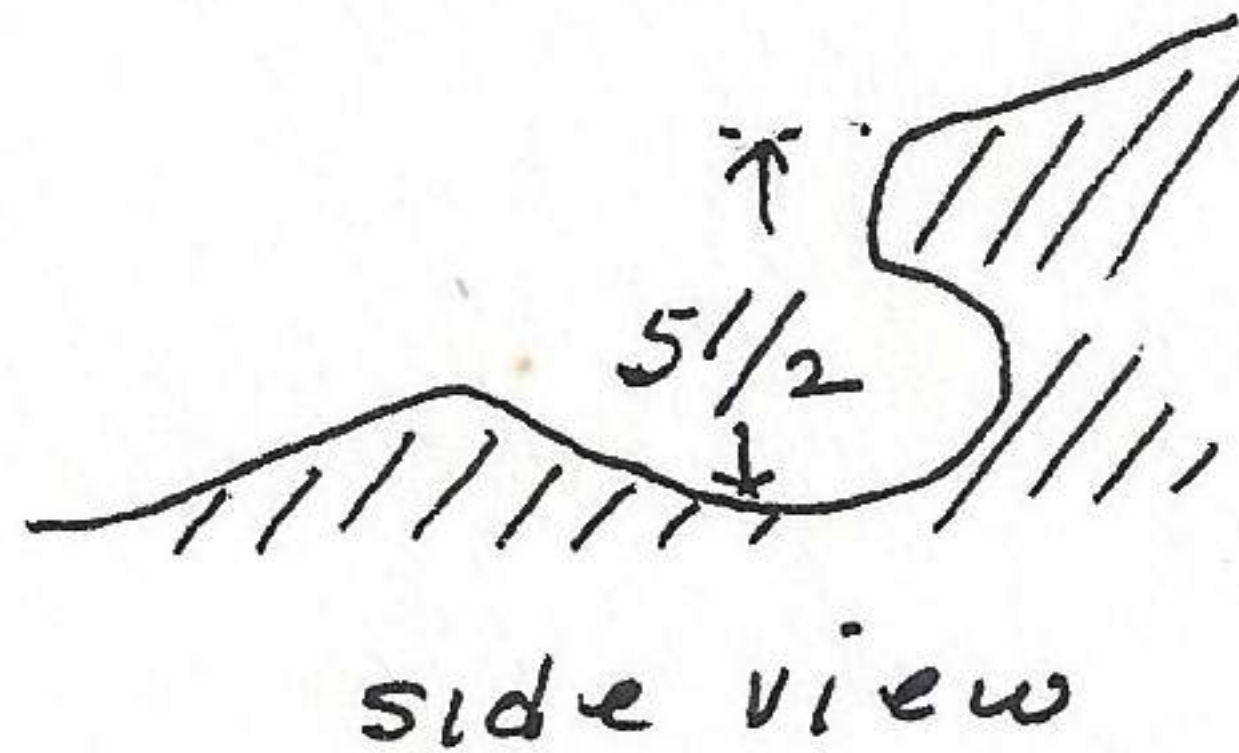

the area. Presumably the rabbits moved about after dark.

The nest was in a dog proof enclosure (used for children) some 20x20 feet. It had not been used this season except once or twice for a dog pound. The ground ^{was} bare except a few patches of grass. Surround the pen was a road, building and trampled ground use by the many children and dogs and cats in the housing area. The nearest usable area for the rabbit was 500 feet away.

The choice of this unusual spot could have been prompted by 2 factors:

1. protection from dogs and children.
2. use of preestablished hole dug by dogs. The hole used by the rabbit was one of three shallow holes dug by dogs when they were enclosed.

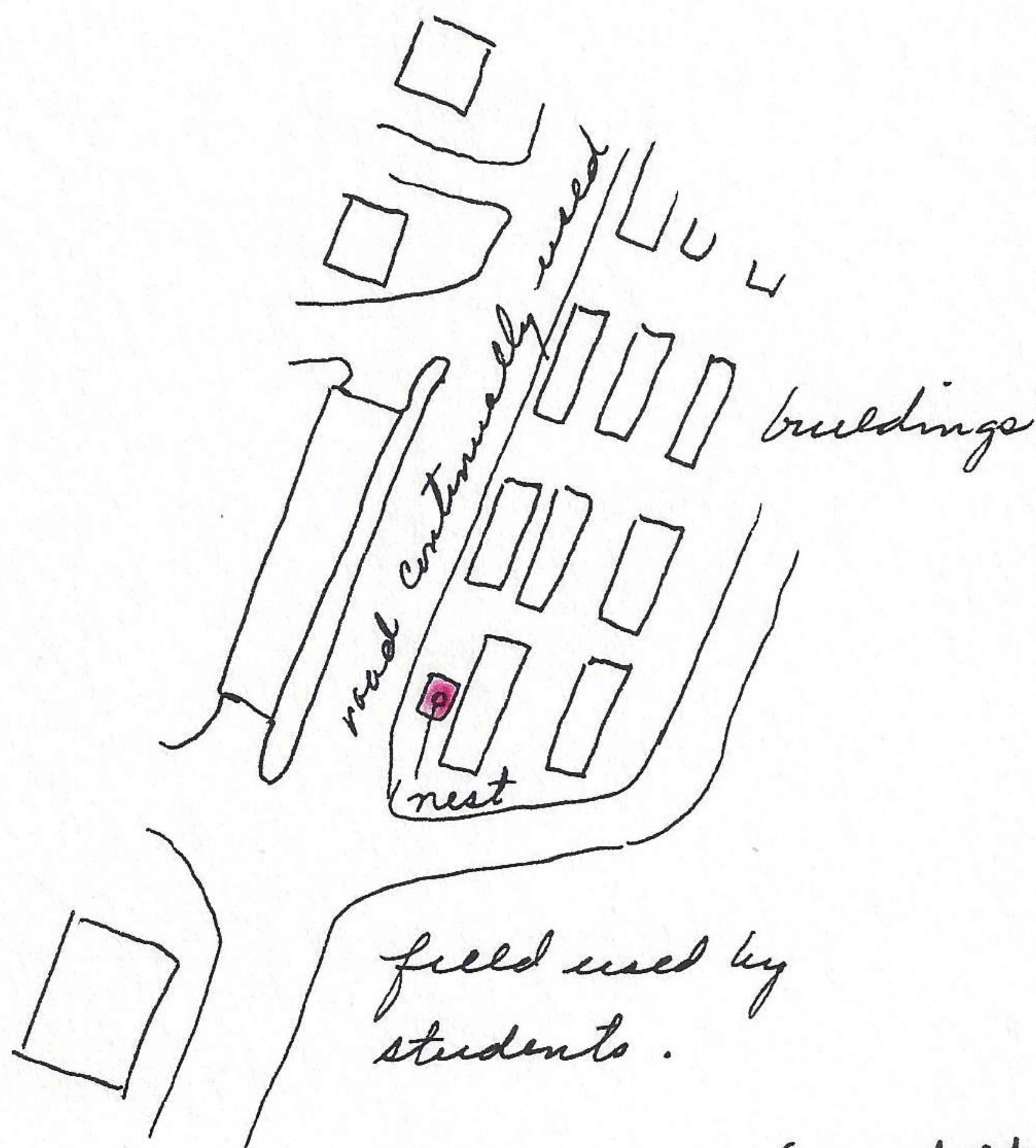

(see letter April 7, 2 pages beyond)

Museum Natural History, Lawrence, Kansas

April 17, 1952

Observed 2 *Chaetura pelagica* circling above museum at