

## JOURNAL 1954

Museum Natural History, Univ. of Kansas, Lawrence, Kansas

Jan 9, 1954

Heard great horned owl calling for first time this winter.

Jan. 17, 1954

A golden-crowned kinglet appeared weak and acted unusual. It was feeding on the grass beneath a pine tree which had branches 2 feet from the ground. This bird would allow one to approach to within  $\frac{2}{3}$  of a meter before flying 2 or 3 meters to another part of the ground under the same tree. After approaching 7 times it flew across the street. Last few days extremely cold,  $10^{\circ}$  to  $20^{\circ}$  F. It seemed to me that the bird was weak from starvation or cold.

Wakarusa River, Lawrence, Douglas Co., Kansas

Jan 18, 1954

Annette C and I walked the Wakarusa from bridge on Highway 59 to a point  $3\frac{1}{2}$  miles directly to the east.

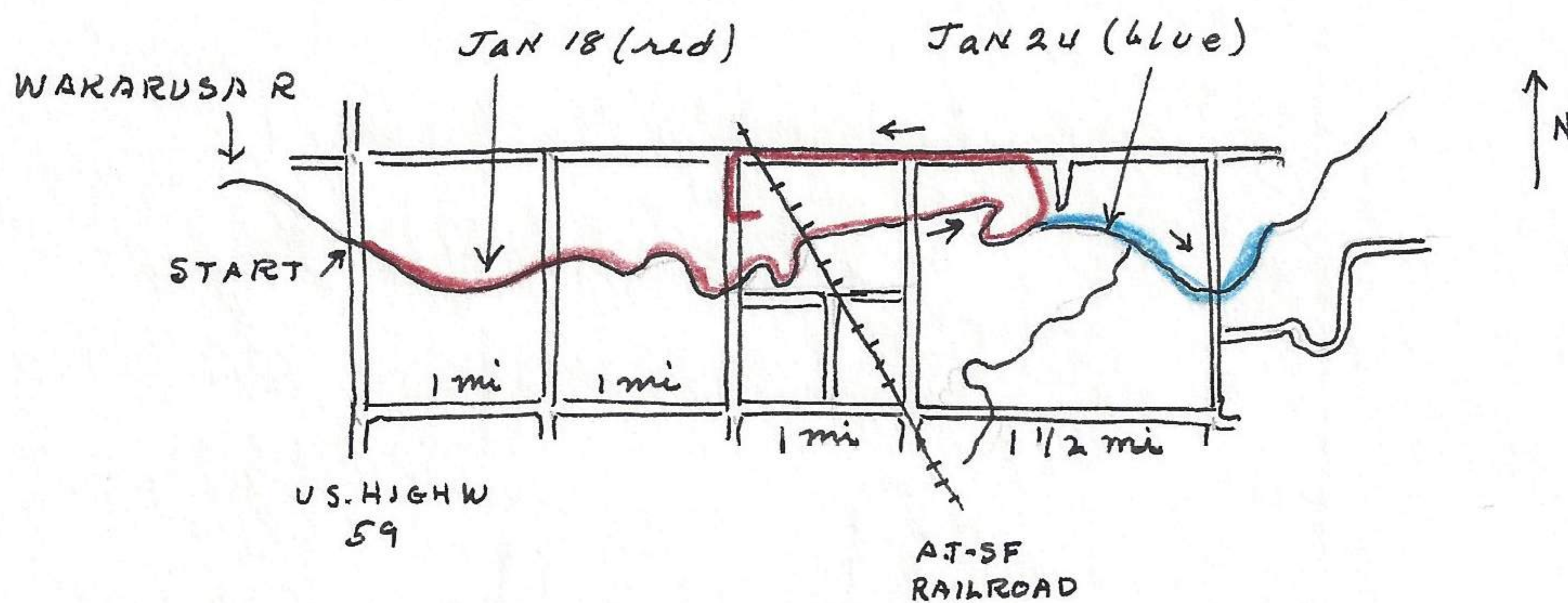

For the entire length the water, except where dry river bed, was completely frozen and in many places to a depth of 10 inches. Dry parts of river approximately 20% of total river course but varied according to section, for instance the river below the railroad crossing and to the east for a third of a mile was about dry. The first 2 miles was 85% water and the last mile was nearly all in water (ice). Springs account for the water in the lower part of the river traversed. Fish were under ice and small ones near edge. The area of about 2 inches below the ice was