

The geese were in two flocks, one above 23rd street and the other about 19th street.

Wakarusa River, Douglas Co., Kansas

March 28, 1960

measured water level of Wakarusa River at 6:00 P.M. It was 11 ft 6 in below the bridge (on Louisiana Street.) as measured from top of girder support

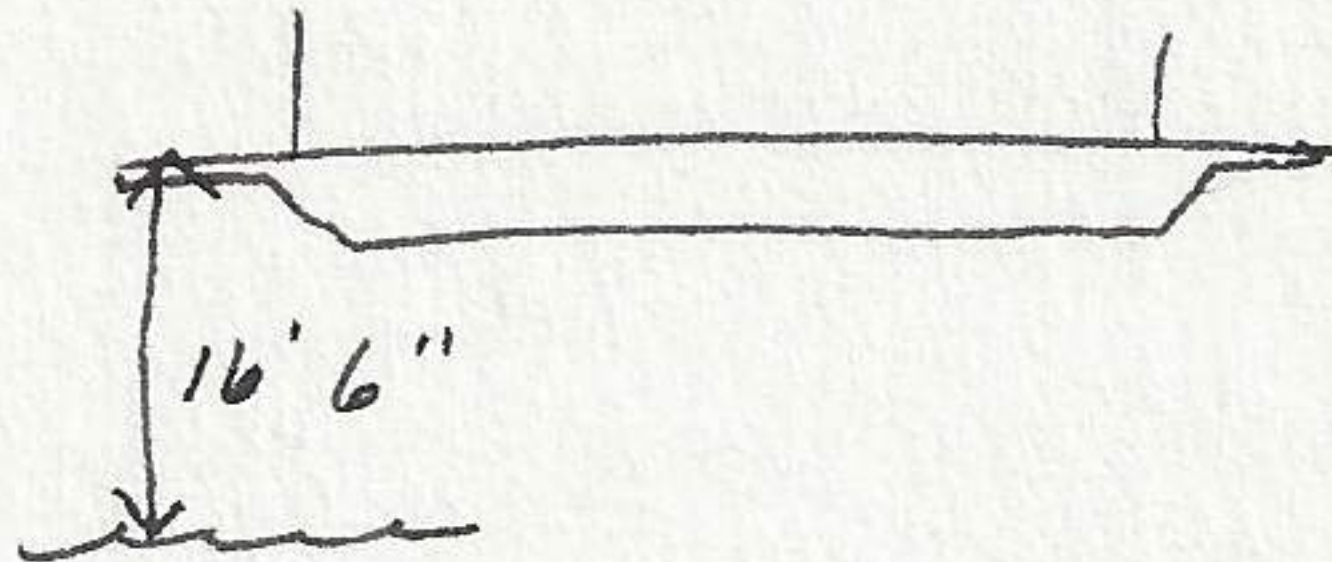

March 29, 1960

water on Wakarusa 18 feet below bridge as measured above.

University of Kansas, Lawrence, Douglas Co., Kansas

April 1, 1960

Identified tree immediately north of the Chancellor's home as being Sophora japonica. This tree has been the source of food since the first of January, of a small flock of cedar-waxwing and occasionally robins. The seeds of this tree are similar to a bean in shape and are approx. this size . They are harder than one can break with ones teeth and are enclosed in a fleshy capsule which might actually be the source of nutrition for the birds.

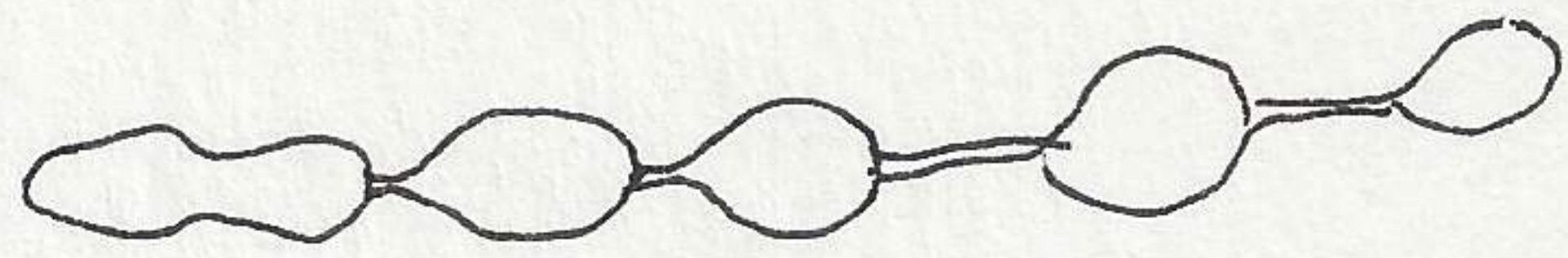

slightly smaller than natural size.

Haskell Bottoms, Lawrence, Douglas Co., Kansas

April 3, 1960

Annette and I walked around dike and road in Haskell Bottoms. Dike dry but field still saturated and at least 1/4 in standing water. Did not see a

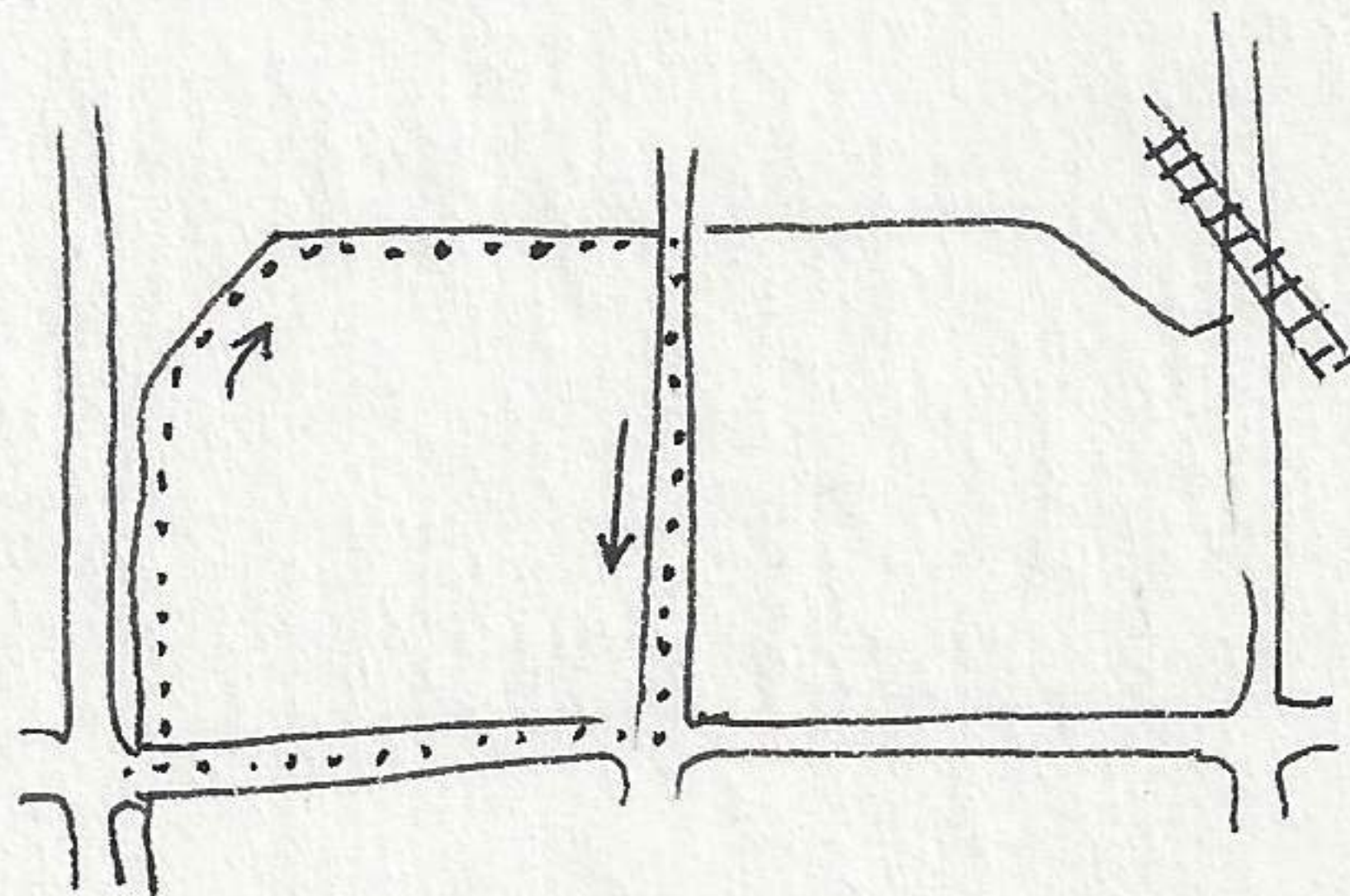

living Sigmodon nor evidence of trails currently used by Sigmodon. many abandoned tunnels of the mole, several of them having been used by small animals as winter runways, probably Thomomys maniculator. The partly collapsed tunnels connected to some trails used by Microtus ochrogaster. Only three fresh diggings of the mole were noted. Ordinarily there are several hawks, mainly marsh hawks, in the area but we did not see any hawk except one redtail which flew over the area. Three Wilson Snipe were