

There were many other birds in area, especially small warblers etc that we did not have time to examine because of the fast currents and because of the condition of the weather.

On subsequent trips check the cross-sectional level (cliff formation) at low stretches of the river, for instance it was noted there was a second set of cliffs beyond the high water level that must have been produced by the Kaw River at high water stage. It would be interesting

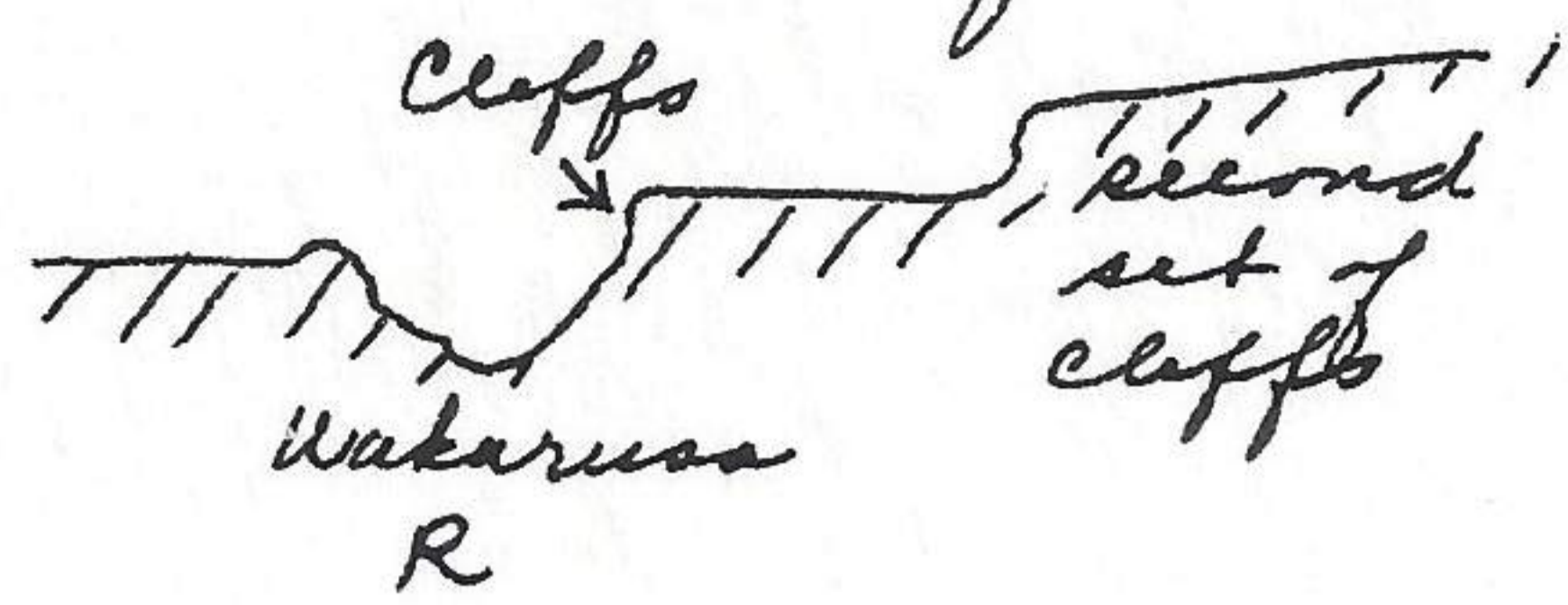

to see if other levels are discernible beyond the second set of cliffs. Also it is recognized that the Wakarusa River varies in speed of flow and width of channel. See if it is correlated with other topographical features such as rock exposures, entrance of side creeks, grade of stream etc.

1600 Louisiana St., Lawrence, Douglas Co., Kansas

May 16, 1961

noted 2 redheaded woodpeckers copulating on top of a utility pole. Their activity attracted 2 chimney swifts which circled overhead at 10' and 3 individual starling, each flying toward the top of the pole to within 2 feet of the woodpeckers and then continued to tree beyond. One woodpecker left and flew into a tree 20' beyond and was repulsed by a starling that had a nest in the same tree. Starling are usurping holes which would otherwise be used by native birds. I have passed this spot 4 times a day but have not observed red-headed woodpeckers in the area this season. They are either secretive or have just recently set up a territory in the area.

approximately
2 mi S and 2/10 mi E Lawrence Star (City), Douglas Co., Kansas

May 18, 1961

Mr. Norman Frank Uvora, a student at the Univ. of Kansas, collected an artifact point (610518-1) at the above locality, west of Lone Star. Dr. Carlyle Smith of the Museum of Natural History, K.U., identified it as of Pre-arrow dating from 500 B.C. to 2500 B.C. used before development of pottery or bow and arrow. The

location was in a creek bottom in an area dominated by deciduous trees.

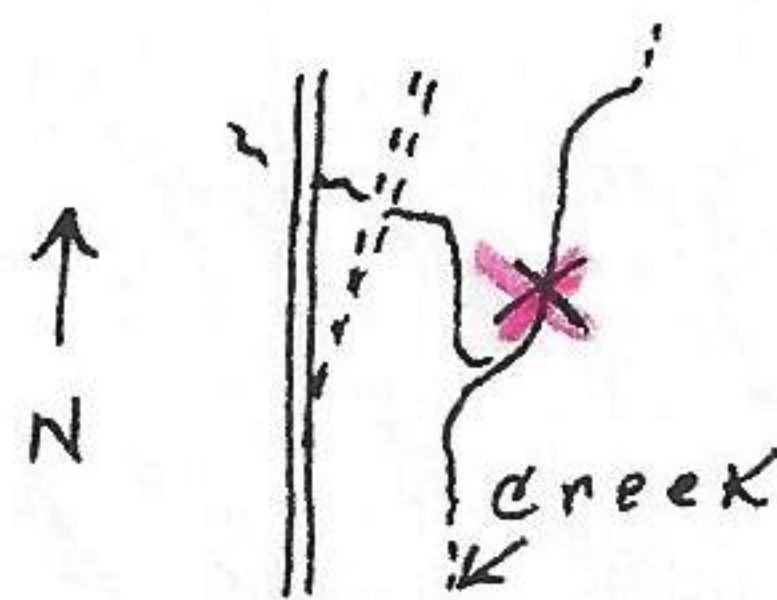
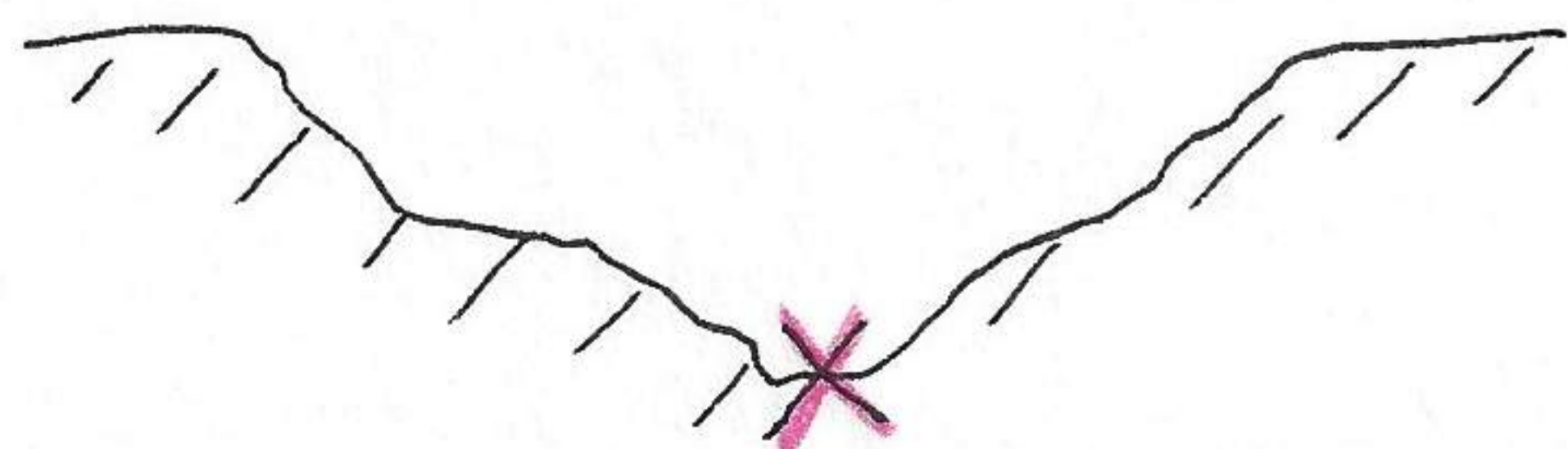

General topographical features of the canyon where the point was found.