

QUARRY
O T T T
red building

UTAH LAKE

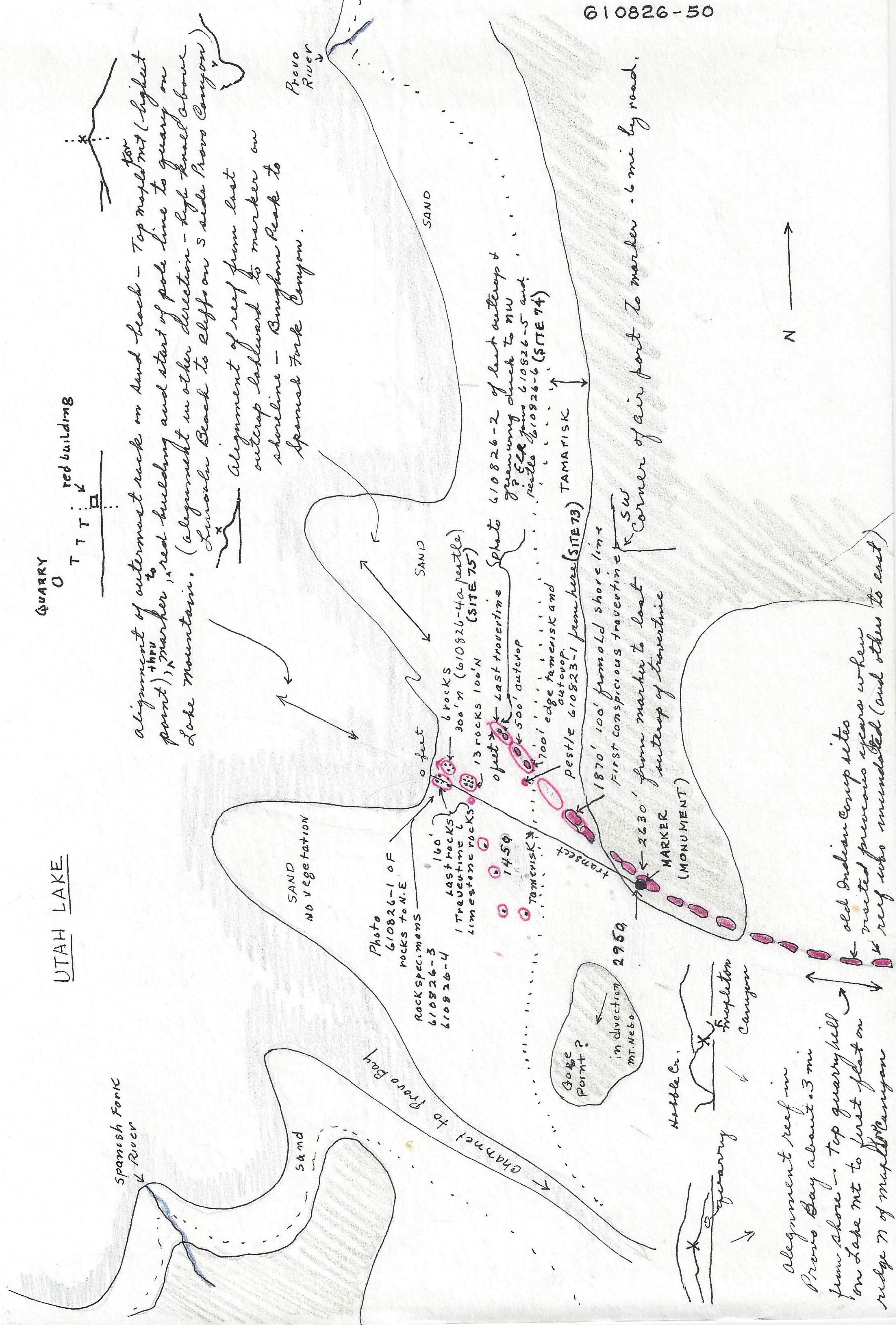

Alignment of outermost rock on sand beach - Top maplet mt (highest point), marker, red building and start of pole line to quarry on Lake Mountain. (aligned in other direction - high knoll above Linslow Beach to cliff on S side Provo Canyon)

Alignment of reef from last outcrop backward to marker on shoreline - Bingham Peak to Spanish Fork Canyon.

Photo 610826-2 of last outcrop & quarrying ditch to NW
? Ell from 610826-5 and
? Restle 610826-6 (SITE 74)

1870' 100' from old shoreline
First conspicuous travertine
MARKER (MONUMENT)

2630' from marker to last marker
outcrop of travertine

2959

Alignment reef in Provo Bay about .3 mi from shore - top quarry hill on Lake mt to first flat on ridge N of maplet Canyon

old Indian Camp sites
marked previous years when reef was inundated (and others to east)

