

Haskell Bottoms, Lawrence, Douglas Co., Kansas

February 3, 1962

Made census of *Microtus ochrogaster* runway in Haskell Bottoms about 3 mi. S Lawrence (P.O.). This same area has been checked on several occasions in previous years (see notes)

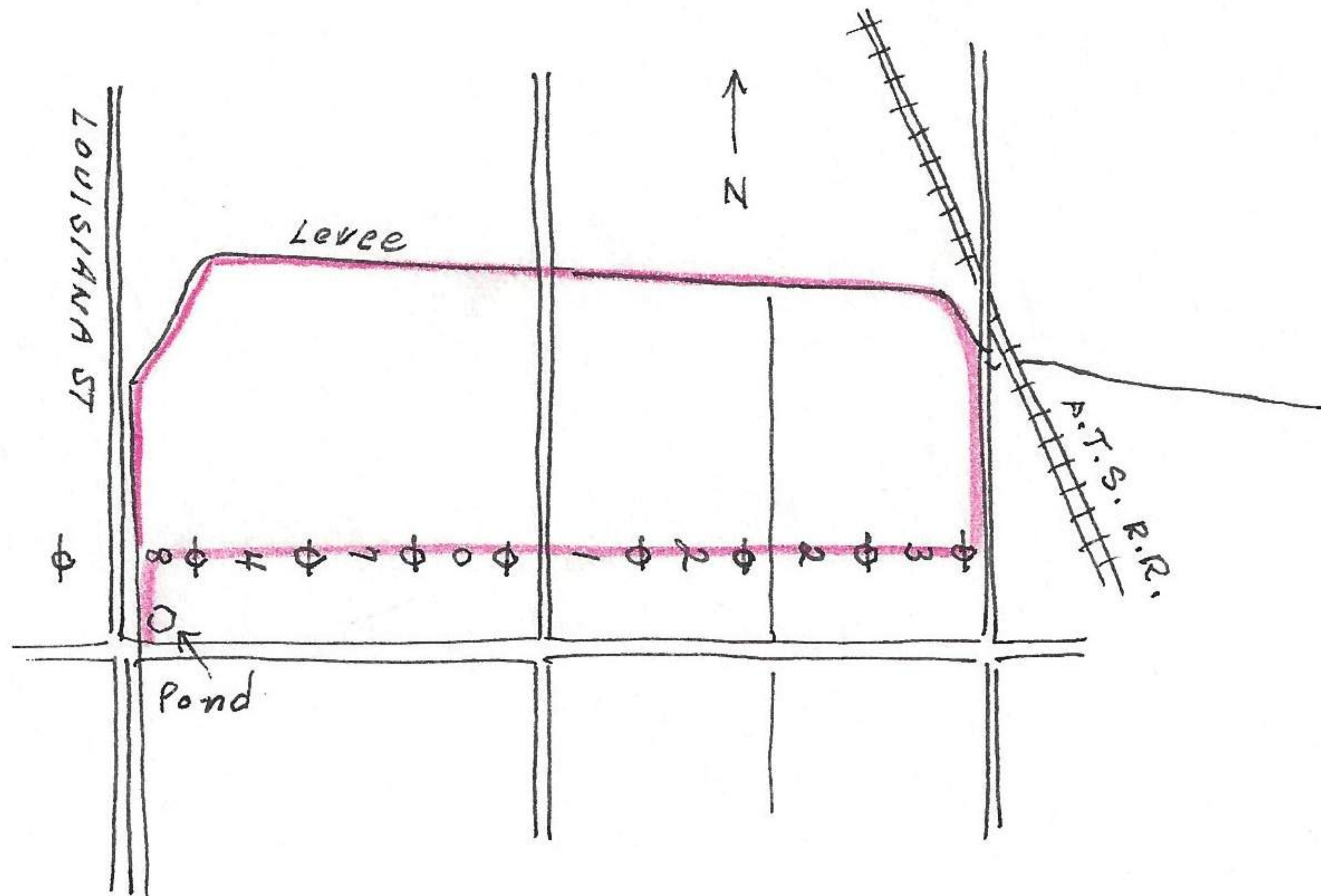

and consists of counting runways in one mile of grassland from Louisiana Street east to Haskell Avenue (E). The area 5 feet wide and 1 mile long in a line through the south pole of the double pole utility line was the transect examined. The number of runways counted are indicated on the above diagram there being 27 in all, or 538 for the entire area of the $\frac{1}{2}$ square mile area. All runways presumably *Microtus ochrogaster* on basis of trail construction. All snow gone but solid to friable ice on 80% of the water which in turn covered about 70% of surface area, at least from 10 inches to supersaturated soils. Except a few spots of ponds or temporary ponds, the surface of field was covered with *Andropogon* & *Bromus*. This grass was mainly about knee high but visibly good to ground surface. The trails, except in a few cases, were visible and easily counted. They were all well used. Between pole no. 3 and 7 grass good, ice on water; between 6 & 7 like above. There were no trails along drainage creek which at period of high there were hundreds of trails; one shallow pond of cattails ice strong enough to support my weight. There were 5 small birds (savanna's) in one mile stretch. Ice on pond except around edges (SW corner). Continued around dike to west to starting point on pond. Along route noted 14 tree sparrows in groups of 1-2-5-2-1-1-1-1. 2 meadowlarks they called feebly. 3 cricket frogs called weakly. One *Promyces*