

2 6/10 mi. W and 1/2 mi. N Lawrence (P.O.), Douglas Co., Kansas

Dec. 26, 1962

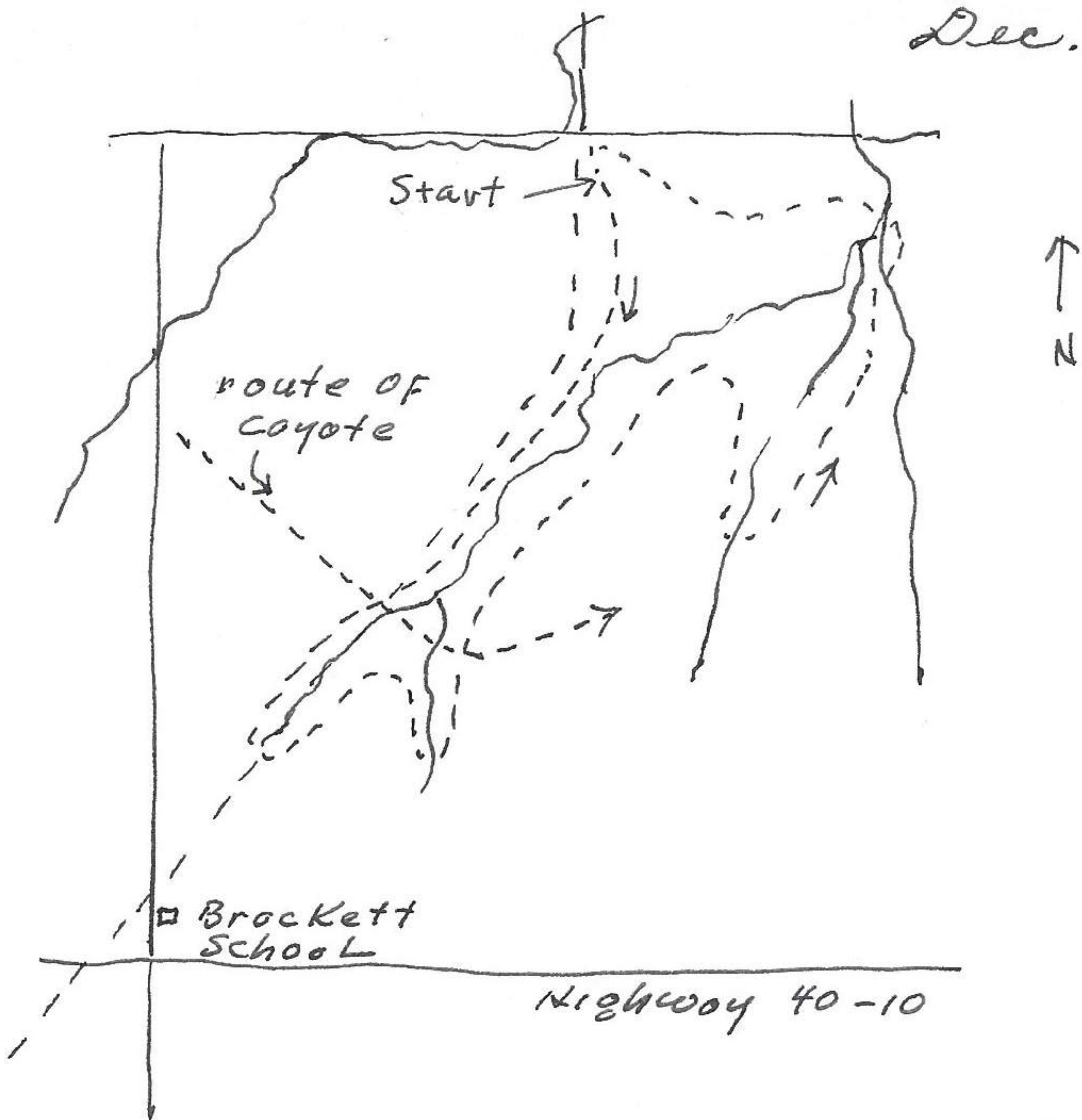

Sam James R., his friend Robert Pearson and myself made short trip to check on birds. From above locality collected the following birds from the upper reaches of the canyon. This entire area is native trees with considerable downed timber. The utility line from the Kansas Power Co runs through the area and produces a cleared area through the forest.

- 621226-1 loggerhead shrike ♂
- 621226-1a *Pipilo erythrophthalmus* 200 mm t.l., 44gms wt. ♀ ovary <sup>5mm long</sup>
- 621226-2 Golden-crowned Kinglet 102 mm t.l., 5 1/2gms wt. ♂, testes 1 3/4 long
- 621226-3 downy woodpecker

Cottontail rabbit numerous, there being tracks at least every 20 feet or so, some areas concentrated. Observed 15 but there were probably many more. One coyote crossed canyon in a straight forward course even though we shot at it once and hit was within 20 feet of point where the coyote crossed the canyon. This coyote had been chased by dogs in the canyon to the west and had escaped to this canyon. Other tracks of coyotes and fox in this area of rabbit concentration.

3 9/20 mi. S and 7/20 mi. W Lawrence (P.O.), Douglas Co., Kansas

Dec 30, 1962

at a point above to 1500 feet east along the <sup>south</sup> east side of a level that parallels a county road through the Haskell Bottoms, set 75 traps at 20 foot intervals.

