

this morning at the Clyde Husted farm (9 miles northwest of Lawrence). The birds left and photographed in the air before they returned again. [The photograph in the paper was marked out in to units and counted - 1762 individual birds in the air]. The geese stopped at a 30-acre lake on the Husted Farm.

1620 Tennessee St., Lawrence, Douglas Co., Kansas
 March 29, 1965

Watched an Eastern grey squirrel (*Sciurus carolinensis*) cross an area of 280 feet, a part of which was connected by upper story treetop.

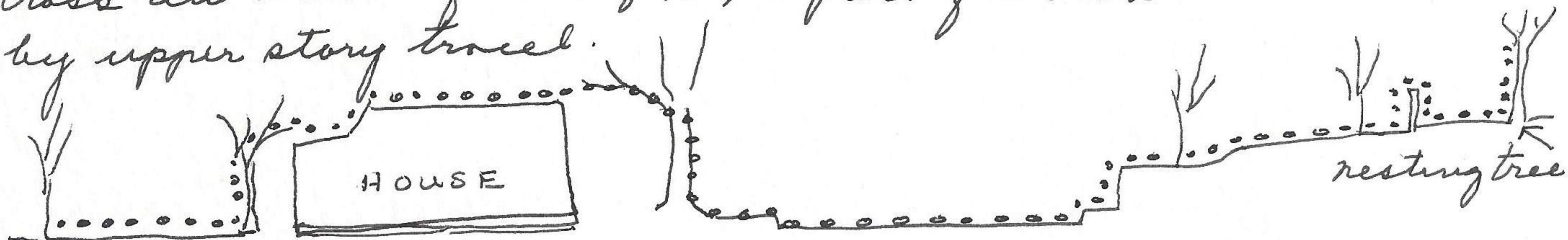

Rather than follow along the ground the entire way, it chose to take the overhead route up a tree, across the top of the house and down another tree rather than along the driveway between the two houses. Also it climbed over a wooden fence rather than go thru the open gate which was directly on its way. It carried a half eaten walnut shell in its mouth the entire way. This kind of squirrel is frequently seen on the Maupin-McCloskey estate and probably had foraged 280 feet beyond its home range. The longer overhead route is associated with its tree inhabiting habits.

Also observed a *Sciurus niger* in tree at back of house. This squirrel is a bob-tailed squirrel and has been in same area or group of trees since several years ago when it first lost its tail in a transformer on a utility pole adjoining our property. It has never been seen beyond the area or more than 150 feet from its home base. This female squirrel has given birth to several squirrels which remain in the same general area. With the lack of the tail of this animal it has modified its habit of navigation. Instead of the lightning action of other squirrels of the same species, it runs more on the order of a cottontail than a squirrel. Its movements are more direct and forceful than other squirrels. While it remains in the same general area, it seems to be absent or less conspicuous at some times than other times.