

48  
48  
48

South side Wakarusa Valley, SW Clinton, Douglas Co., Kansas

May 27, 1965

Annette<sup>P.</sup> and I made census of birds on S side of Wakarusa Valley, SW Clinton. Objective: to determine percent frequency of birds in three different ecological communities; one produced by man (A to B) of chemically treated hillside deciduous

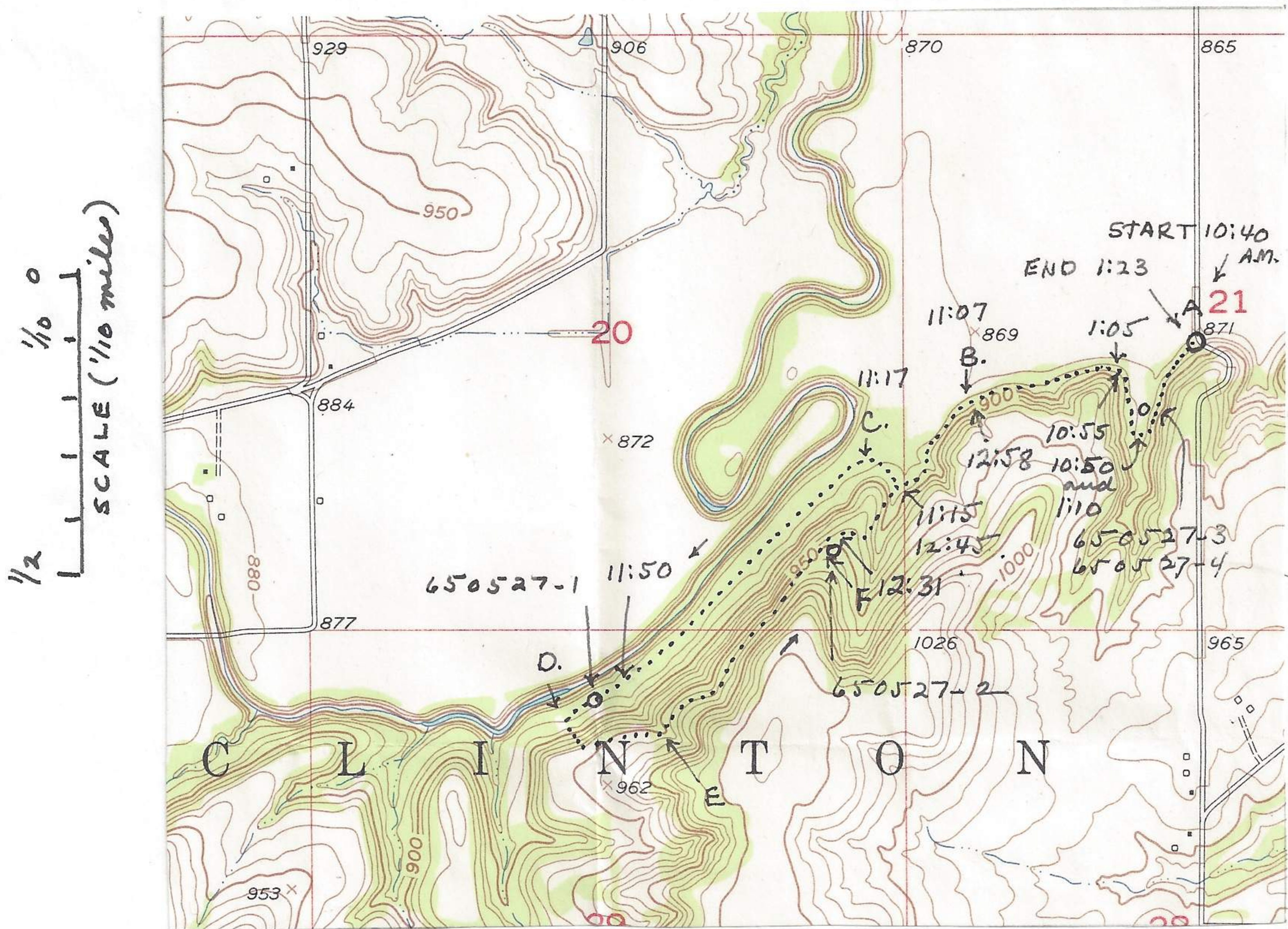

forests, now mostly dead standing timber without leaves; B to C is hillside deciduous forest, slightly modified but not chemically; C to D. climax riparian forests, dense like tropical forests and on flat from valley flood plain (upper story, understory and shrub); E to F hillside deciduous climax.

Enroute from Lawrence (via paved highway to turnoff west of Clinton) made a list of the birds observed. Left home 10:10 at 267.3, temp 62° F. meadowlark, robin, English Sparrow, starling, dickcissel, barn swallow, 2 great blue herons flying above creek at Washington bridge, grackle, red-winged blackbird. S end of proposed dam of Clinton Reservoir 75.8 mileage (will keep complete census across proposed dam area to starting of main census), 5.9 red winged blackbird, 5.9 meadowlark, red wing blackbird, chimney swift, 6.3 3 dickcissels, Eng Sparrow, 6.5 dickcissel, 6.6 red winged blackbird, 4.7 dickcissel, meadowlark, 7.0 dickcissel, 7.1 Rock Creek bridge, 7.2 dickcissel, 7.3 red-headed woodpecker, 7.4 Eng. sparrow, 7.6 dickcissel;