

algae, some of of substantial growth with considerable relief. The channels have a weak circulation of water to main river. One muskrat was using one of these upper channels which was isolated from the main section of the channel. It left bank in plain view (6 feet from water) and entered pond of open water before disappearing under the shallow ice.

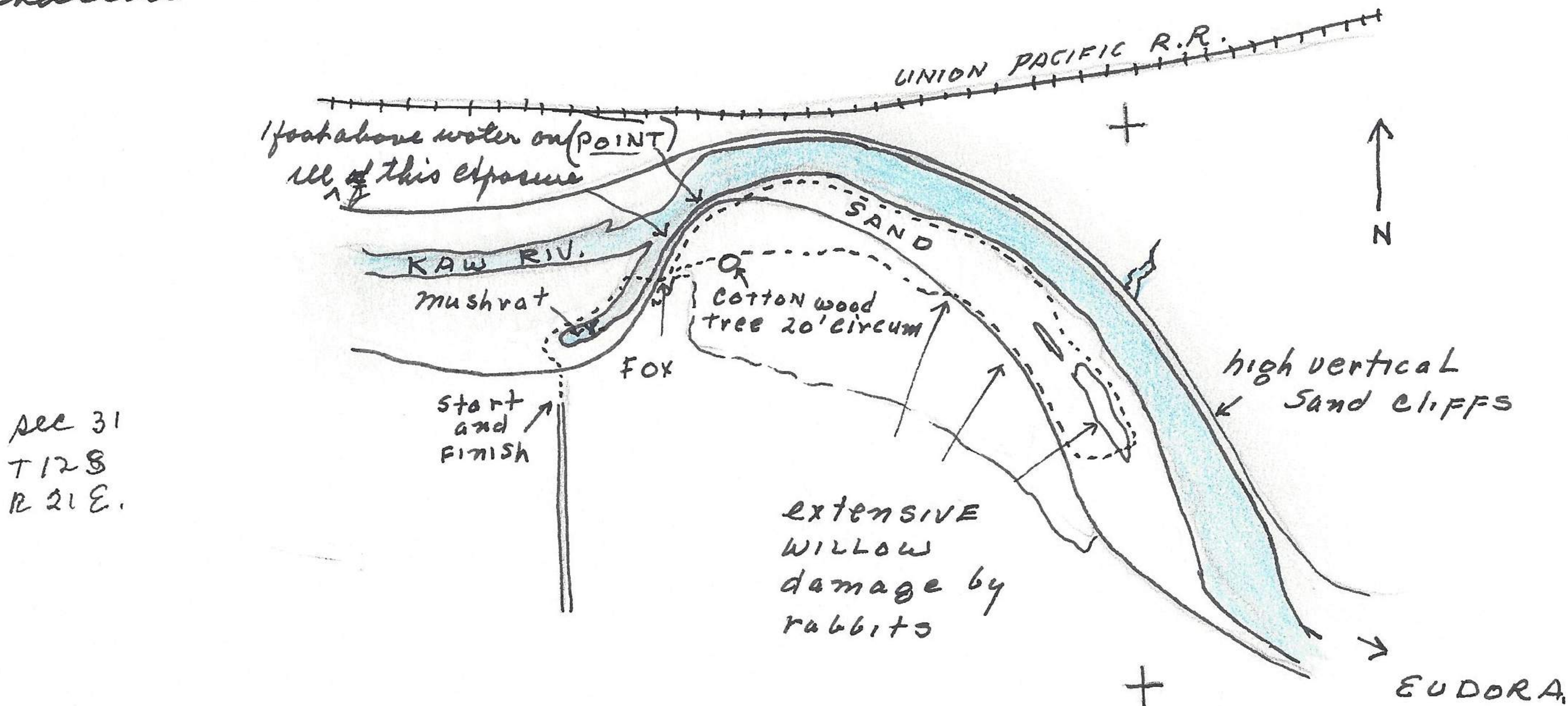

At Point noted gravel at water level with high sand bank superimposed. Canal extend down river and smaller particles on sands above. Birds along bank rare, ^{only 3 horned lark on sands} but include 18 song sparrows, 2 cardinals, 2 blue jays, 1 red-bellied woodpecker, 3 black-capped chickadees. no water birds. Beaver cutting + down trees at Point and a hundred feet SSW. no deer tracks on sands except at Point but common in forests to S + E. The forest have some large cottonwood trees, one measuring 20' in circumference. This tree was a double tree and one arm off and on ground almost completed decade but identifiable. Some area with craterlike depression 20' deep. areas of cottonwood with complete covering of gray leaves on ground. area of sycamores show brown leaves against gray ^{leaves} of cottonwood. Floor covering with only a few green ground plant leaves. This ground cover has not been disturbed for a long time. As we crossed thru forest, drove a red fox to high bank. It left, and as we gained edge there was no fox to be seen in any direction. It was probably hiding in the irregular profile of the high bank, which is one of the characteristics of fox behavior. The small willows along river have been