

Wakarusa Valley, Douglas-Shawnee Co., Kansas

Dec. 31, 1967

Mary & I made complete census of the proposed Clinton Reservoir started at Sigel School at 04698.0, 200 P.M., temp 8°F, sky clear slight wind from NE. Only birds noted between Lawrence & Sigel were 1 redtail & a group of 28 starting and 12 slate colored juncos. At Sigel noted 2 crows, 1 junco. 98.5 4 tree sparrows, cardinal. Creek frozen. 99.1 Y in road. 99.4 2 redtails together in top of tree up creek and about 100 from old nesting site of the redtail.

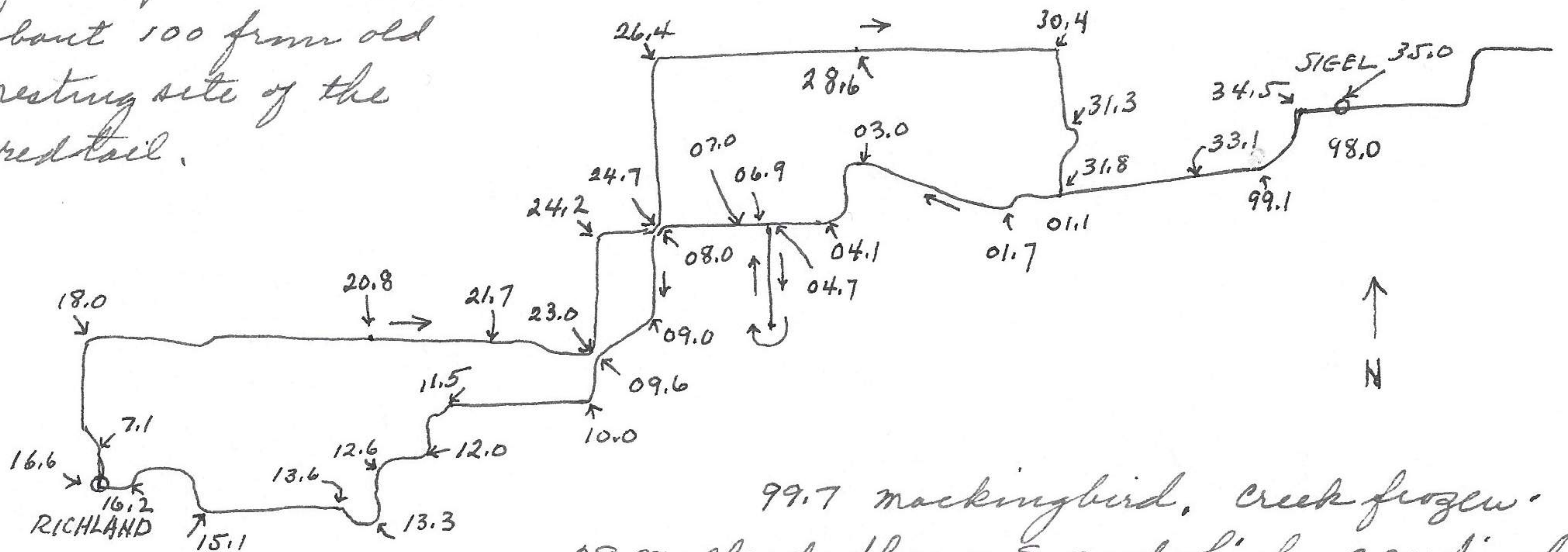

99.7 mockingbird, creek frozen.  
 28 mallards flying 5 and high, 2 cardinals  
 00.6 2 meadowlarks along road, 100 feet beyond & more feeding in road. Recent snows covers ground elsewhere. The meadowlarks alight on weed stems rather than onto snow of ground. 00.8 ~~mea~~ 2 meadowlarks feeding in road. 01.0 meadowlark feeding in road. 01.1 passing by Peterson Rd turnoff. 01.7 Wakarusa bidge. River 4/3 open with ice along sides, 3 juncos. 03.0 passing by bridge. 12 juncos. 03.7 blue jay eating from large seed. 03.9 small bridge 3 juncos. 04.1 main road. 04.7 now to left. meadowlark. 05.7 12 tree sparrows. 05.9 2 horned larks. Numerous tracks along road and made last night, now wind blown. 06.9 now back to main road & to W. 07.0 Belvoir bridge. water 4/5 open. 2 downys. Drifts of snow from wind from E. 08.0 to S. 3 tree sparrows. 08.6 2 redtails. 08.7 small bridge. In a weed patch and associated small trees observed an aggregate of 18 Harris sparrows, 2 cardinals, 28 tree sparrows, 18 juncos. 09.0 to right. 4 juncos. 09.1 6 meadowlarks in brush pile and loathe to leave although only 50' away. 09.2 single meadowlark on brush pile. 09.6 to left, 2 meadowlarks. 09.8 3 flickers on ground and some distance from trees. 8 horned larks associated with flickers (white of front of head clear across) 10.0 to right (road almost indistinguishable but snow drifts not impassible. 10.2 bridge over Wakarusa. 4 cardinals &