

The course of the river up to approx. 11:35 was recorded and then fitted onto regular map (U.S.G.S topo).

12:20 at bend are large blocks of rock with water ripple marks. The rocks in this ^{general} area vary from thin flat to massive blocklike rocks of several tons wt.; Chickadee, flycatcher (g. crested), 2 cardinal, titmouse, 10 goldfinch including 3 males, Great horned owl left tree bordering river.

12:33 bend. 12:34 ♂ woodduck left edge of river, called, and flew down stream.

12:40 now to SSE; 2 cardinals, chickadee, titmouse; good riffles below; yellow warbler; Baltimore Oriole ♂; vireo sp.?

12:50 redtail hawk left tree bordering river. A great horned owl left tree and alighted down river about 300'. 2 cardinals, 2 great crested flycatchers, and a redbellied woodpecker reacted to the presence of the owl. 12:53 Swainson thrush; 2 chickadees; Catbird and titmouse. 12:57 6 goldfinch, 2 pewees, titmouse (the titmice are not calling as they do in earlier part of spring). 1:00 cardinal. 1:15 2 cardinals, pewee, chickadee. 1:25 rocks in large slabs with shale above to left. cardinal. 1:29 5 chimney swift in area and they do not seem to be associated with houses or habitation. 1:31 2 cardinals, pewee, chickadee. 1:40 mourning dove nest with 2 eggs 1/2 incubated. nest 4 feet above water and constructed on

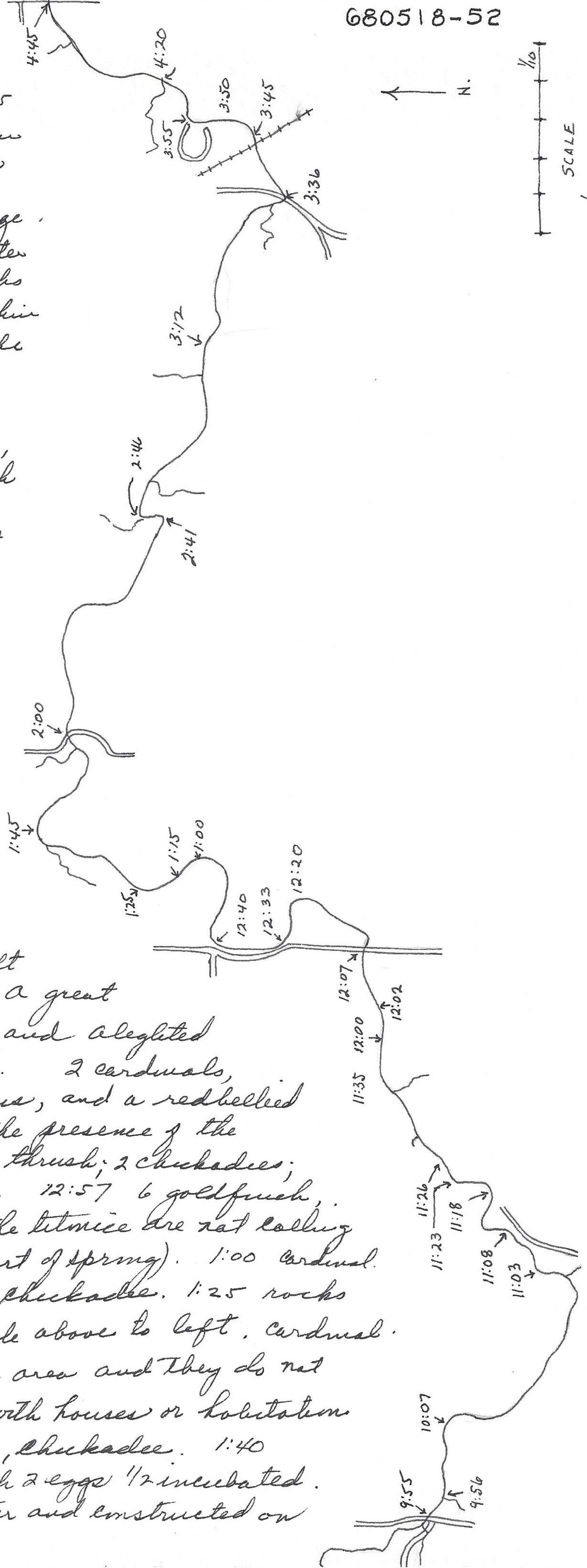

SCALE

1/10 MI INTERVALS

U.S. G.S. TOPO (1955)