

at one time the two birds dropped to ground from 40' high in tree and during entire descent were at contact with each other. The descending bird called continuously. A second male arrived and was likewise repelled. 11:27 head of open plowed field but following forest trail to left. 11:30 3 eastern bluebirds, 1 downy, 11:34 west side plowed field at Lock Creek. Fox squirrel. 2 red-headed woodpeckers calling continuously from sycamores on N side creek. 2 blue jays. (stopped 10 min + started again at 11:45. Water on ice in creek, some areas open. No snow on sedgehills or river bed beyond ice. 11:52 first drainage (from hillside road) 2 red-headed woodpeckers calling, 3 blue jays. 11:54 2nd major (flat) drainage. yellow-shafted flicker, red-bellied woodpecker, 4 tree sparrows. Ice in trail and there only. No snow. 12:00 8 tree sparrows low in shrub growth, blue jay. 12:01 titmouse, downy, 2 red-headed woodpeckers, fox squirrel, 2 red-bellied woodpeckers. Noted one red-headed woodpecker following a downy (listed above). 12:05 old pioneer house (basement pit only). Red-breasted nuthatch here. The house foundation is approx: 20' x 14' juniper (approx 75" in diam circumference).

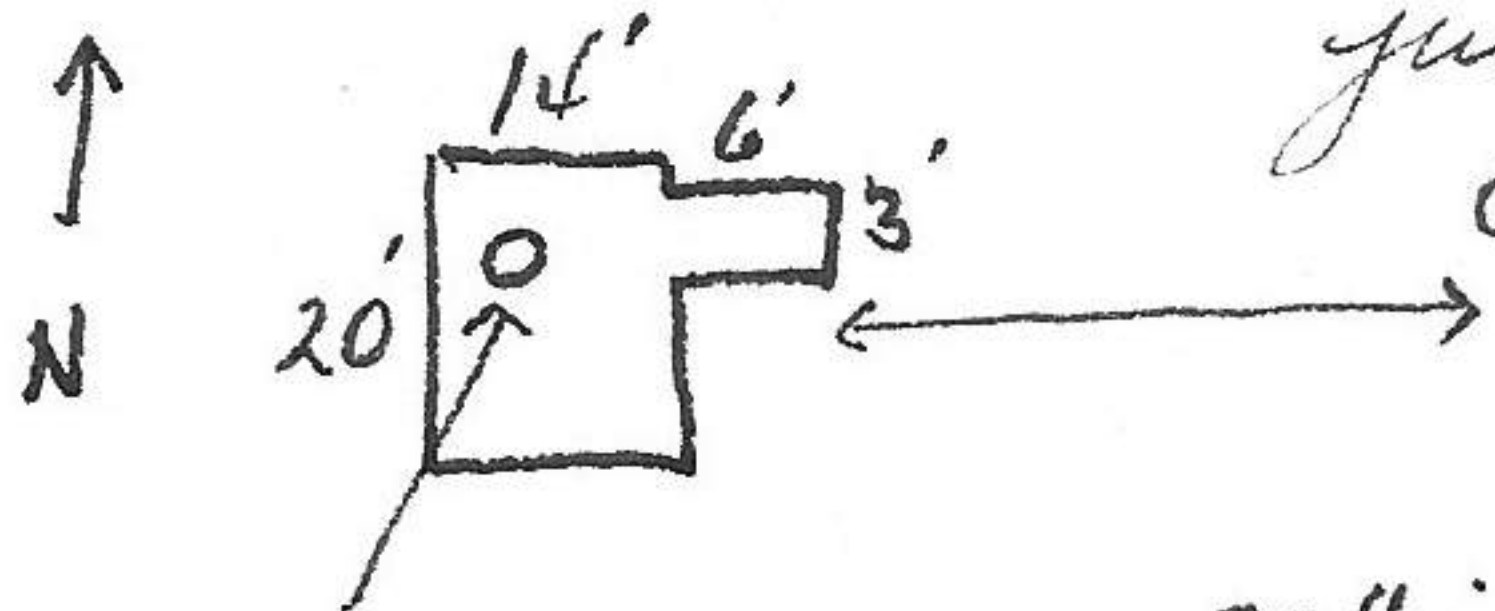

oak(?) tree approx. 32" in circumference. (3 other smaller trees in pit slightly smaller). It would be interesting to excavate this site. No wood remains. Other birds in this area are redtail, 3 black-capped chickadees, blue jay, 1 red-bellied woodpecker. Left 12:14 12:16 major drainage + deep. Cottontail at edge. 12:17 red-headed woodpecker. 12:18 2nd drainage and deep (parallel or from some canyon above). A red-headed woodpecker called continuously & at a much faster rate than usual call of separate calls (warning), blue jay. 12:23 b.c. chickadee. 12:24 b.c. chickadee, 2 robins in top of tree (high), 2 blue jays. 12:25 5 b.c. chickadees, 1 red-bellied woodpecker. 12:30 trail now toward S. 2 blue jays. 12:33 Convergence of stream from S. Ice above convergence, open below across 2 ripples & pools. Water clear. Air following under ice at edge and appears as if animals running along side of ice. Titmouse calling as in spring & summer, blue jay. Left convergence at 12:37 (good vantage point). 12:38 2 titmice. Opposite meander with three large sycamores. Another good vantage point 12:40 fox squirrel, titmouse. 12:43 crossing creek. red-headed woodpecker, blue jay. 12:46 open field 12:47 5 b.c. chickadees, one calling with faint call. 12:53 bridge

