

Clinton Reservoir area, Douglas Co., Kansas

May 20, 1973

Investigated ridge south of the south end of the proposed Clinton Reservoir dam. Left home at 402 Yorkshire at 8:00 A.M. Enroute recorded kinds of birds (highway 59 - blacktop Clinton Rd.), Eng. sparrow, robin, purple martin, Baltimore oriole, barn swallow, grackle, dickcissel, red-bellied woodpecker, mourning dove, house wren, starling, chimney swift, lark sparrow, crow, western kingbird, redheaded woodpecker, cardinal, sparrow hawk, loggerhead shrike,

Started at base of N end of ridge at 8:30 A.M. will continue to top of N terminal and then to S at about upper $\frac{3}{4}$ of E exposure of ridge to a point to S and then return at the base of the east exposure of the ridge among the trees. On N exposure observed Baltimore oriole, 2 grackles flying S overhead, 3 crows in field to N., red-eyed vireo, bobwhite, cardinal,

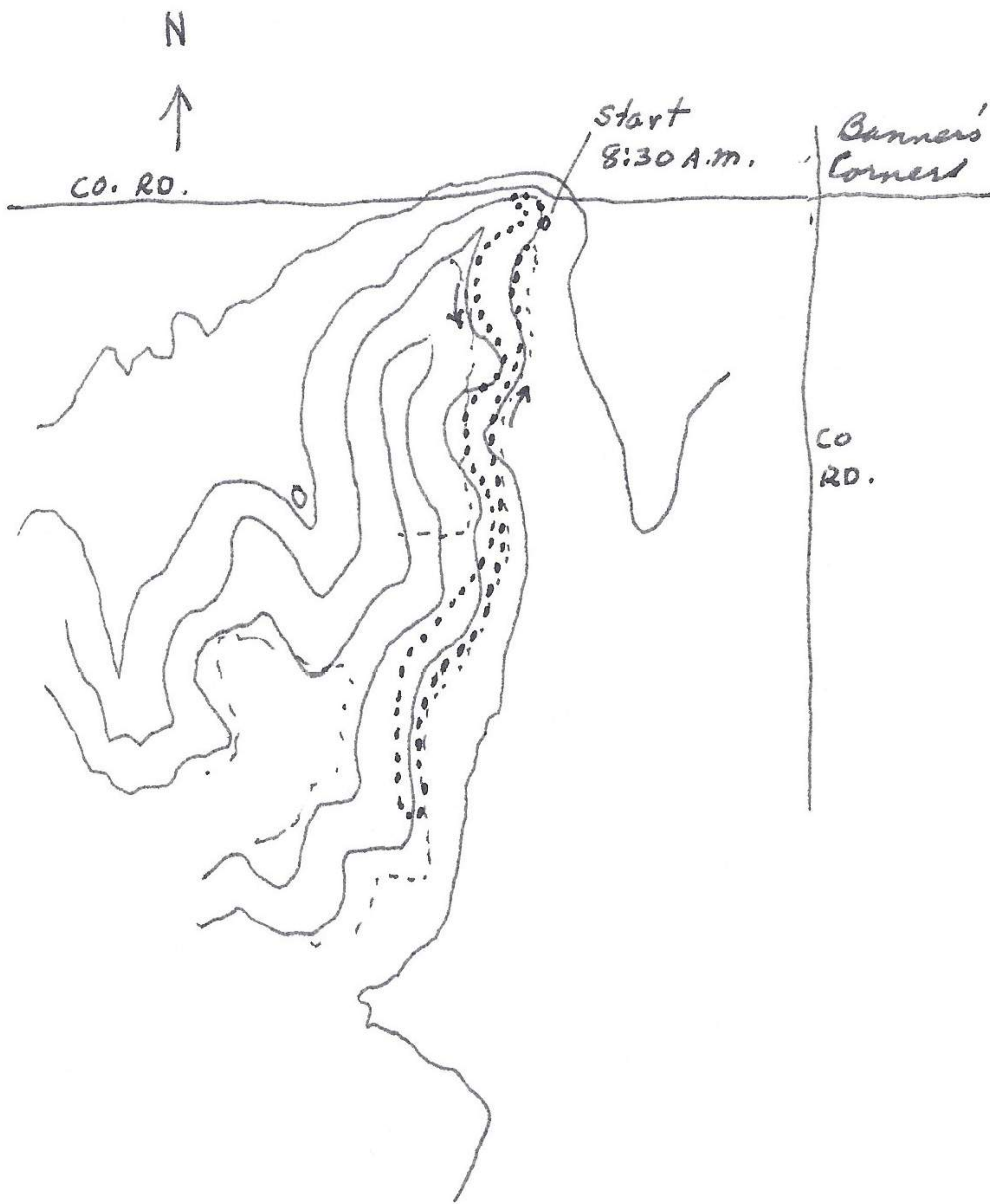

gnateater, redtail sunning on top tree, 2 bluejays calling, mourning dove calling. Juniper knoll 8:45. brown thrasher, 2 crows, cardinal, 2 titmice here. Downslope to E to lower point before traverse of main ridge. Redhead woodpecker calling. no wind and sky clear. Birds uncommon.

From this vantage point saw hear Baltimore oriole, cardinal, bobwhite, redwing, titmouse, redhead woodpecker, brown thrasher (feeding on ground among trees), black-capped chickadee, oven-bird, red-bellied woodpecker.

9:57 crossing drainage near top. yellow-billed cuckoo, great crested

2 titmice, red-eyed vireo, 1 chickadee, flycatcher, 3 crows among trees below, 9:00 second drainage, 9:02 3rd drainage, 9:03 4th drainage. 9:05 5th drainage. Crows calling vigorously below as if harassing a great horned owl. 9:15 fence line. 25' beyond this fence to S is a large