

1974-44-41661

740602-47

of the total kinds and numbers of birds observed in clearing I would estimate that 2 or 3 indigo buntings were the only birds utilizing the areas where forests were recently removed and these birds in the 3-4 foot high young trees just starting to develop. Nearly all other birds were associated with the more stable lowlands beyond former forests or in areas of grasses or vegetation that was formerly under cultivation among trees or on open slopes or low lying fields.

Lawrence, Douglas Co., Kansas

June 12, 1974

Dr. Lins reports that the albino dickcissel is still on territory and in the afternoon when traveling to Vinyard, sees this male more often than not. It is located approx 1.5 mi toward Baldwin from second turn in main road. This bird has been observed in this area for the second year and in approximately the same area.

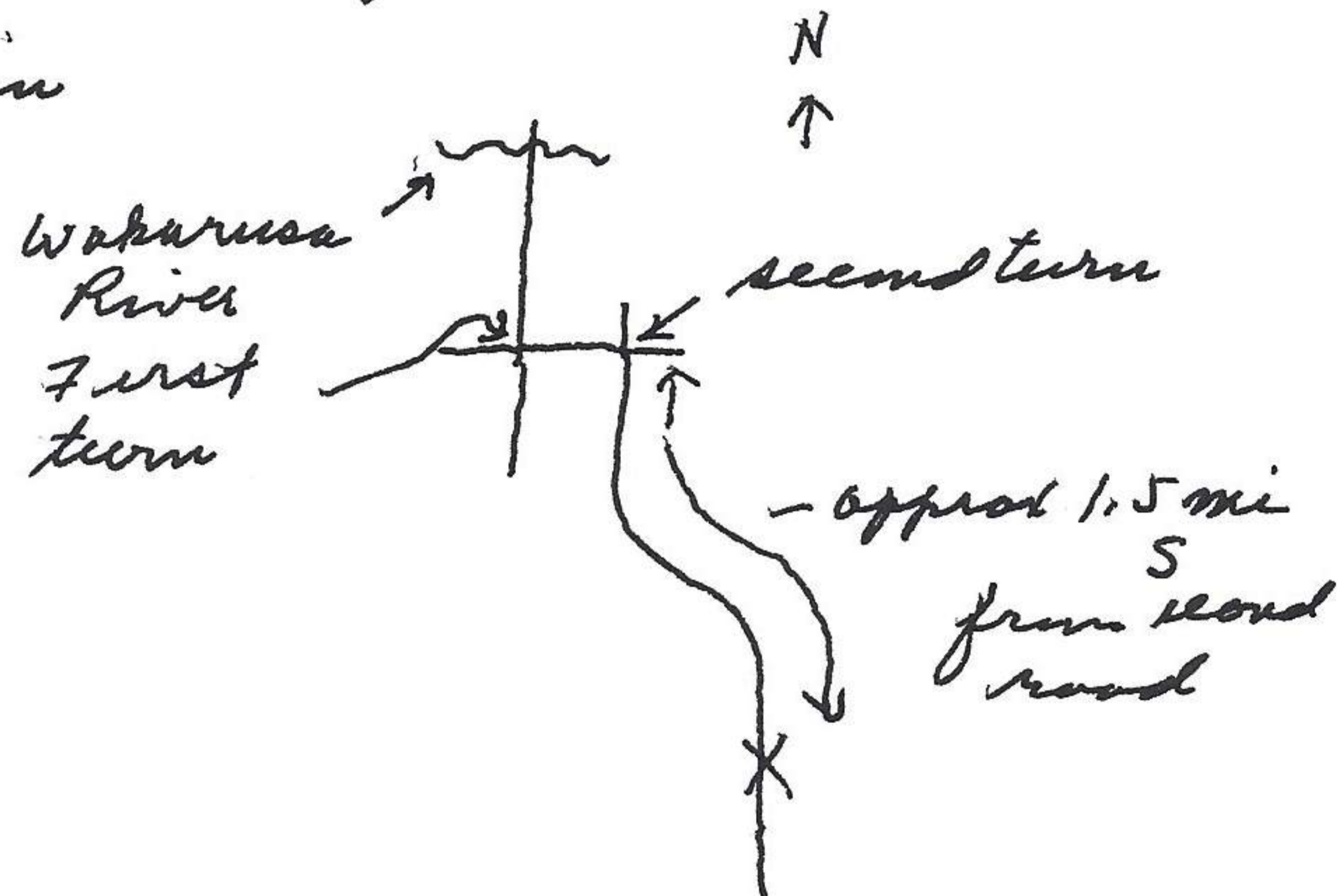

Museum Natural History, Lawrence, Douglas Co., Kansas

June 12, 1974

Noted 2 young jays in lower branches of a small white pine. They were able to move from one branch to another.

June 13, 1974

Some young jays in same position in tree. Adults feeding. One jay was measured as 138 mm in total length and when returned to the tree flew to ground and then in 2-3 foot flights moved down hill. It was captured and returned to tree with other young bird.

June 14, 1974

Only one young jay was noted in white pine in usual area. This evening did not see the young in usual area.

Kaw River, Santa Fe Railroad Station, Lawrence, Douglas Co., Kansas

June 15, 1974

On the Kaw River 1/2 mi. N of the Santa Fe Station at 413E, 9th Str. and at approx 20 minutes before sundown, noted an adult male purple martin in the water in about the center of the river. At the distance observed, it suggested a large fish surface with its