

760318-31	<i>Microtus ochrogaster</i>	142	28	19	12	34 gms ♂	testes 12 mm
760318-32	"	140	33	18	12	33 gms ♂	testes 12 mm
760318-33	"	139	28	19	11	40 gms ♀	5x0 emb 12 mm
760318-34	"	157	36	19	12	39 gms ♂	testes 13 mm
760318-35	"	147	36	10	11	33 gms ♂	testes 13 mm
760318-36	"	142	35	19	11	36 gms ♀	4x0 emb 19 mm
760318-37	"	142	28	19	12	35 gms ♂	testes 12 mm
760318-38	"	140	28	19	11	40 gms ♀	1x4 emb 12 mm
760318-39	"	147	36	10	11	34 gms ♂	testes 13 mm
760318-40	"	156	36	19	12	38 gms ♂	testes 13 mm

1 3/10 mi. N, 1 1/20 mi. W Lawrence (P.O.), Douglas Co., Kansas

March 23, 1976
 Mr. A.R. Wells, 2321 Westchester in Lawrence, reported 2 purple martin in the area of his home. He considers these as scouts and they are later than most seasons. Set traps NW home. western boundary along utility line from R.P. and light, the north line along fence bordering turnpike and the east line a short distance down old fence line into forest.

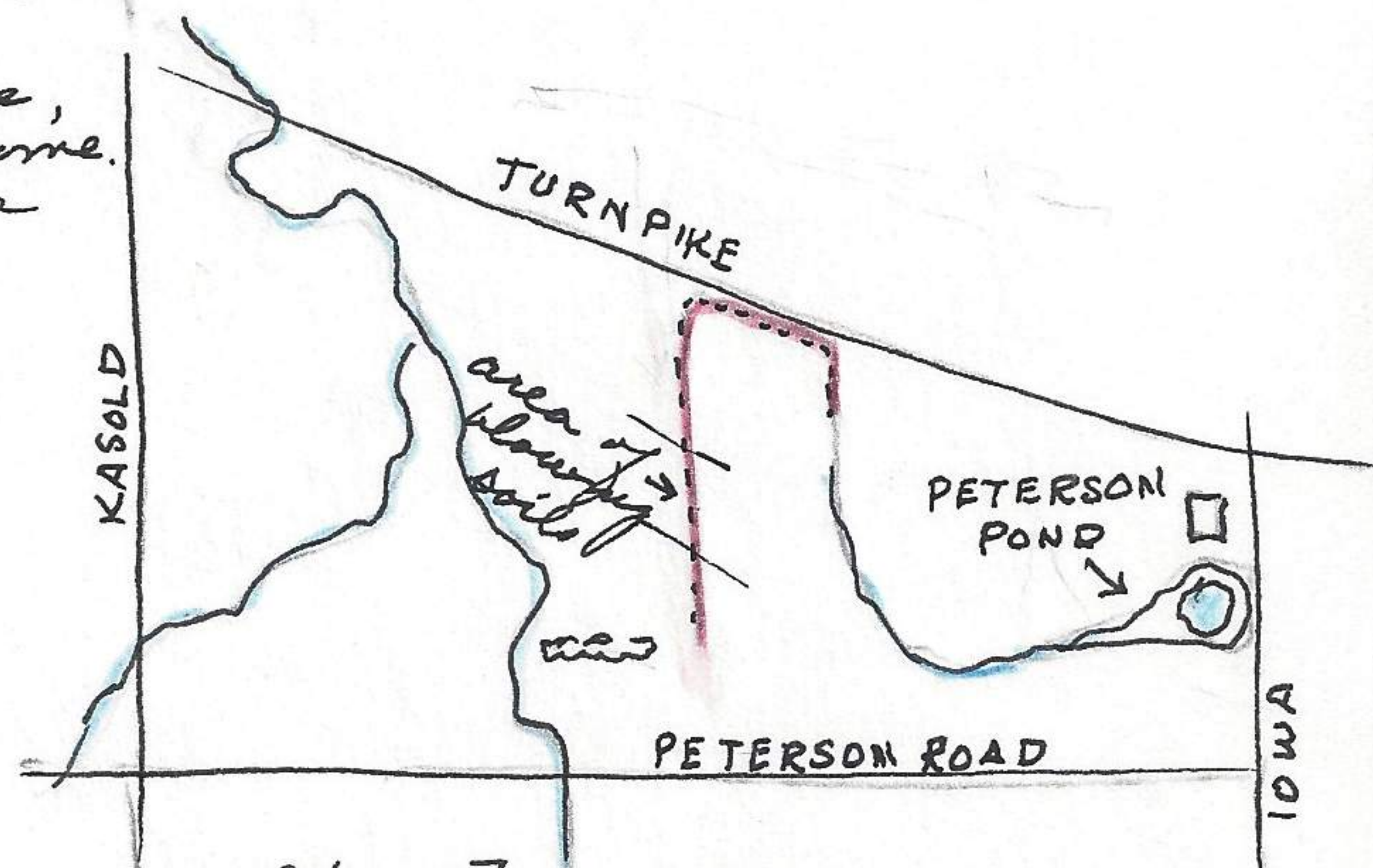

March 23, 1976

From above collected:

760323-1	<i>Spermodon hispidus</i>	272	114	34	17	142 gms	testes 18 mm
760323-2	"	261	107	32	17	124 gms	testes 17 mm
760323-3	"	248	100	30	17	90 gms	3x2 emb 10 mm
760323-4	"	236	100	30	17	98 gms	testes 17 mm
760323-5	"	218	84	29	17	100 gms	testes 18 mm
760323-6	"	236	94	29	17	95 gms	testes 16 mm
760323-7	"	225	88	28	16	85 gms	testes 16 mm
760323-8	"	250	95	28	16	107 gms	testes 18 mm
760323-9	"	253	95	30	17	106 gms	♀ 2x3 emb 7 mm
760323-10	"	230	89	29	16	85 gms	♂ testes 17 mm
760323-11	"	225	89	28	16	71 gms	♂ testes 18 mm
760323-12	"	220	82	28	17	52 gms	♀ ut normal
760323-13	<i>Peromyscus maniculatus</i>	135	55	18	13	12 gms	♂ testes 9 mm
760323-14	"	133	51	18	13	12 gms	♂ testes 9 mm
760323-15	"	139	56	18	13	15 gms	♀ ut normal
760323-16	"	128	48	18	13	12 gms	♀ ut normal
760323-17	"	148	58	19	13	13 gms	♂ testes 9 mm
760323-18	"	143	53	18	13	20 gms	♀ 4x0 emb 6 mm
760323-19	"	128	46	19	13	17 gms	♂ testes 9 mm
760323-20	<i>Reithrodontomys megalotis</i>	132	61	16	12	8 gms	♂ testes 6 mm
760323-21	<i>Microtus ochrogaster</i>	146	34	19	10	34 gms	♀ ut enlarged