

13/10 mi N, 115/20 mi. W Lawrence (P.O.), Douglas Co., Kansas

March 26, 1977

From trapline of 50 museum snap traps set along utility line from Kansas Power Co along fence line grown to grasses. Plowed field to W, cut grasses to east

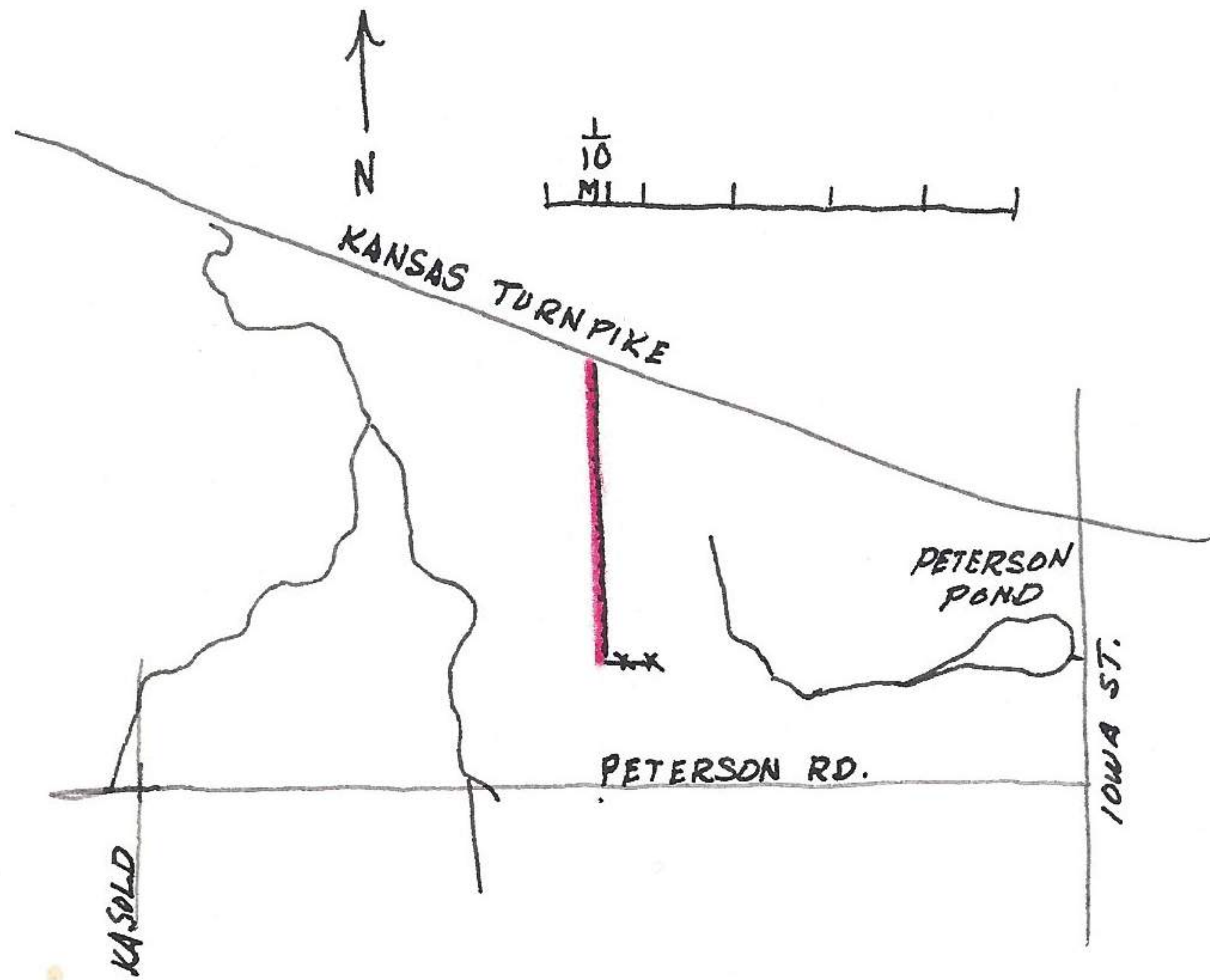
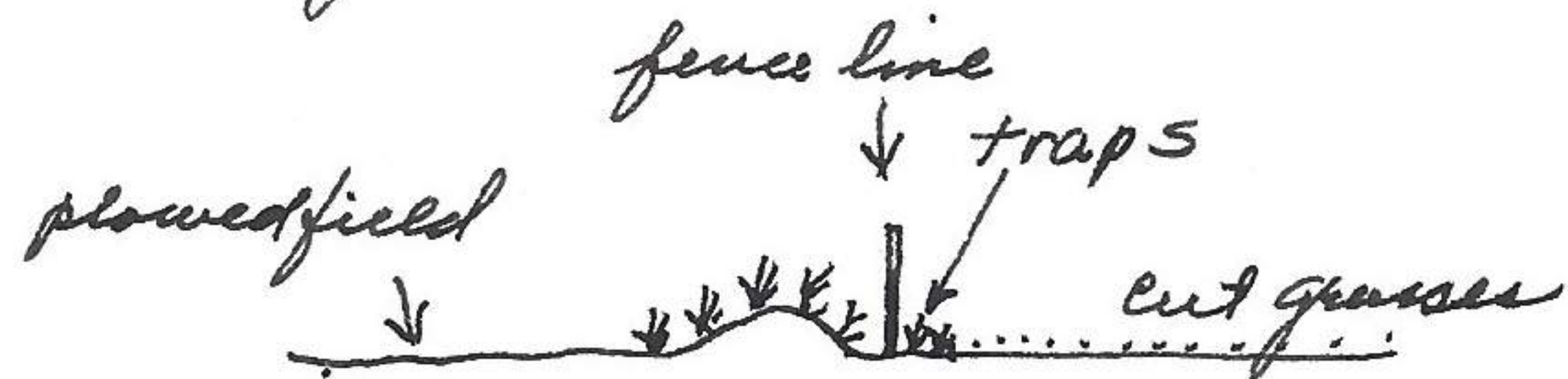

This fence line has been trapped on previous years and these records should be compiled for trends. One year most mammals were *Synaptomys*, last year *Sigmodon* this spring neither. It is surprising that this area repopulates itself after repeated trapping as if removal of mammals makes more space for more mammals.

770326-1	<i>Microtus ochrogaster</i>	151-32-20-11-43 gms ♀
770326-2	"	151-32-20-11-59 gms ♀
770326-3	"	158-35-20-10-
770326-4	"	144-28-20-11-40 gms ♂ testes 11 mm
770326-5	"	148-32-19-11-39 gms ♀ 0x4 emb. 21 mm
770326-6	"	151-31-19-11-43 gms ♀ 2x2 emb 3 mm
770326-7	"	148-36-22-11-39 gms ♂ testes 11 mm
770326-8	"	142-33-20-10-40 gms ♂ testes 14 mm
770326-9	"	154-31-20-11-41 gms ♂ testes 13 mm
770326-10	"	147-31-19-11-36 gms ♀ 1x3 emb 9 mm
770326-11	"	150-31-19-11-36 gms ♀ ut. enlarged
770326-12	"	151-33-20-12-43 gms ♂ testes 12 mm
770326-13	"	155-36-20-10-44 gms ♂ testes 13 mm
770326-14	"	154-33-20-11-63 gms ♀
770326-15	"	153-33-21-11-49 gms ♂ testes 13 mm
770326-16	"	141-31-20-11-32 gms ♂ testes 12 mm
770326-17	"	150-34-19-11-35 gms ♀ 1x2 emb 2 mm
770326-18	"	136-28-19-11-24 gms ♂ testes 9 mm
770326-19	"	127-27-19-10-22 gms ♀ ut. normal
770326-20	<i>Peromyscus leucopus</i>	178-78-23-16-23 gms ♀
770326-21	" <i>maniculatus</i>	143-52-18-15-24 gms ♂
770326-22	<i>Reithrodontomys megalotis</i>	127 55-27-12-5 gms ♂ testes 6 mm