

50 crows, 200 crows all flying E. 536.0 6 sandhill cranes flying E. So far the cranes have been localized along the Platte River Valley. For the first time since leaving Lawrence there is a blue sky to W with overcast sky leaving. 554.6 First large group of duck (500), since the area of the sandhill cranes.

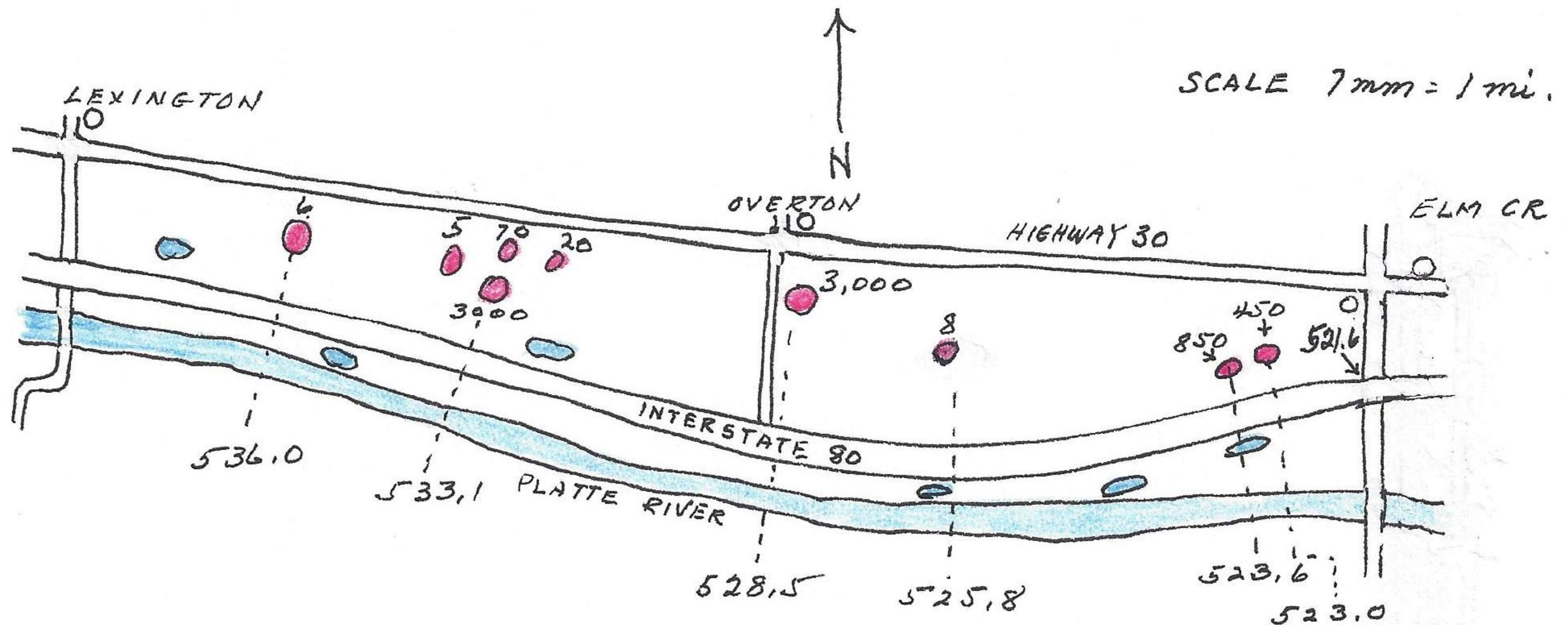

Distribution of sandhill cranes from Elm Creek to Lexington.  
Total of 7,409 individuals.

all barrow pits have a few ducks. drainage ditches put in by man all have a little water. Only a small proportion of farms plowing field and field dusty. Further W we travel the fewer ducks we see. 602.4 North Platte. at 6:30 P.M. at mileage 14604 or 407.3 miles today. Stayed motel 6.

North Platte, Nebraska

March 23, 1980

medical note: tension to 4:30 A.M. then pulse increase & decrease to weak & irregular. missed beat every other beat to miss every 12th beat. By 6:00 A.M. pulse gradually to regular and strong. Bells 10 per minute. Left N. Platte at 14604.3, 7:00 A.M. skies cloudy, no wind. Min. temp. last night 28°F. Redwing black-birds on territories, about 10 per barrow pit area. River valley W of N. Platte all in natural or grazing grasses, meadow-larks and redbirds unusually common in this area. 620.2 barrow pit with 24 ducks and 6 ring-billed gulls. all pits have a few ducks and between barrow pits are singles, pairs or small groups flying in the valley. Ring-necked pheasant walked across road. One mallard water in road right-of-way. 2 sparrow hawks here. Storm front same place this morning as yesterday evening with clear weather in store. First magpie at 624.8. 627.3 red-tail