

NEST SITE GOLDEN EAGLE, W END CASPER MT., WYO.

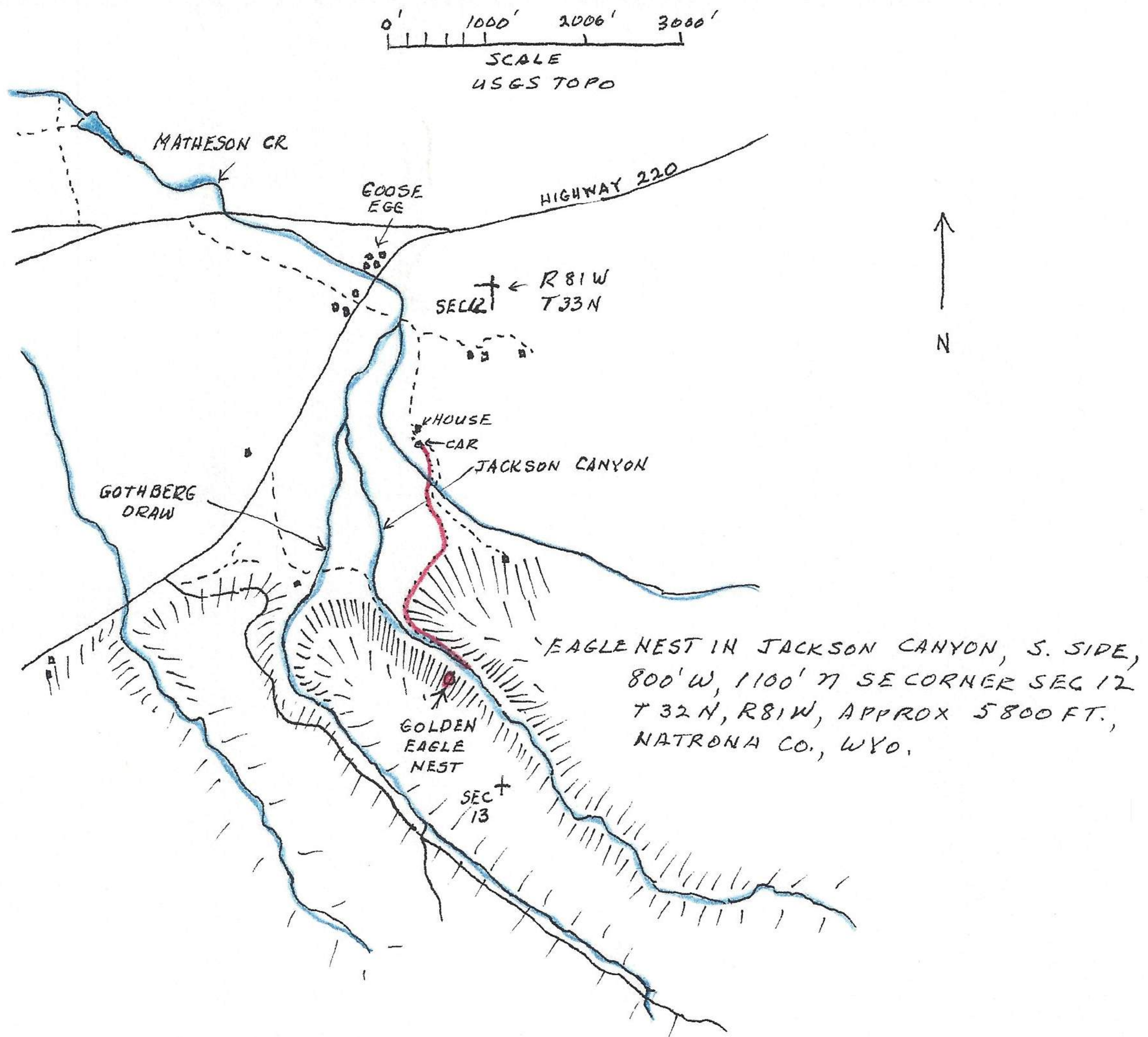

and are dipping steeply to the west. In the upper part of the canyon the floor is rock. The golden eagle nest is on the S side of the canyon about 30' from the base of the cliff. It is approx. 4 feet in height and made of dry sticks of various sizes. These dry sticks go clear to top of nest and there is no indication that the nest has recently been used at least since last year. A rope would be required to reach the nest although it could be viewed and contents observed from higher on N side of canyon. Several large ponderosa pines are in canyon and according to Mr Young are used as roosting perches in winter by bald eagles. He reports that years ago approx 15 bald eagle died in this canyon because of poisoning and along with a similar situation in Jackson Wyoming received national publicity. Photo 800809-1 is of the golden eagle nesting cliff to right. From mouth Jackson Canyon.