

This afternoon went top of sulphur mountain via Gondola left. Bow Valley and Banff below. There are several good scenic shots. Today practically no sun and snow erratic. 12 mt sheep at observation area <sup>at</sup> top of left. They were hand confiding. Summit 7,500 ft. at summit noted golden eagle flying (soaring) south.

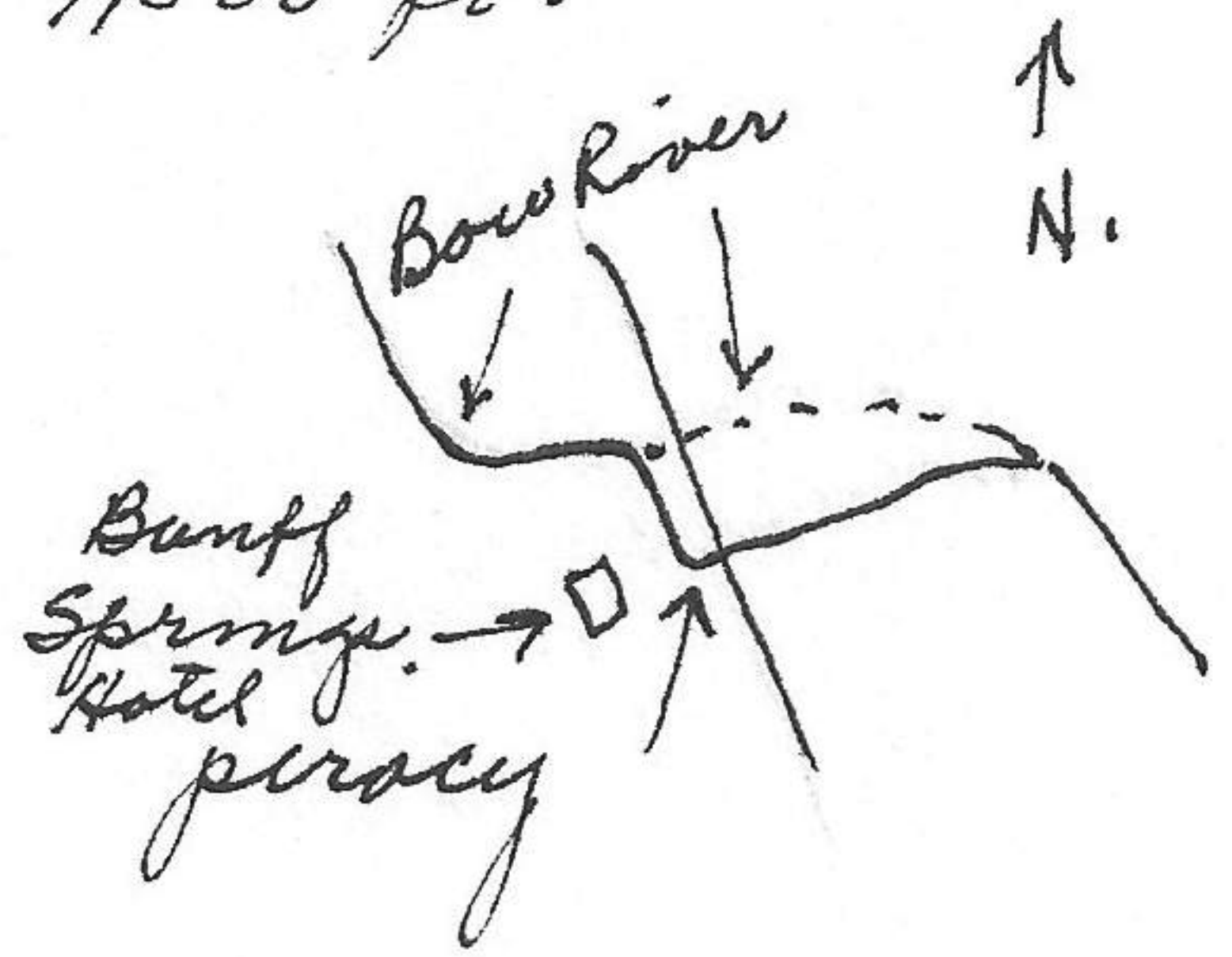

Tunnel mt Camp, Banff, Banff National Park, Alberta, Canada  
Oct 16, 1983

Clear sky except a high haze. 833.1 left camp. Gulls at Banff as far as I can tell are the California gull. At Vermil Lake 9 pintail ducks and 14 mallards. The pintail bob up for feeding and paddle feet on water as if to attain deeper extension of body. Beaver house to W. <sup>2</sup> magpies and 2 mt sheep along road. and one steller jay. 943.4 photo <sup>831016-1</sup> to NW, right hand side in series of cliffs and left in snow covered mt slope, 2 raven. 75% ponds covered with ice, magpie. 2 Canada jay, magpie 948.2 3 white tailed deer, Canada jay. 960.4 Trail head for Taylor and O'Brien lakes. Photo here to W of snow covered mt. no. 831016-2. High mark on edge of river is 1/2 distance of boulder band. 962.1 Coyote 10 feet <sup>river</sup> <sup>soil</sup> <sup>black stain</sup> <sup>mark on boulders</sup> <sup>lighter than above.</sup> of edge of road, turned and walked back into forest, magpie. 964.9 Coyote walked across road, poused on edge of road while a car passed and then walked down onto right of way. Twice it looked back from where it came as if expecting another coyote to follow, Canada jay, raven. Elk foot prints along road. 965.8 photo 831016-3 of imp. like mt. to west. Steller jay. 966.2 at an unnamed bridge, photo 831016-4 of mt top of aretes and snow covered. This is the same mt as 831016-3. 3 Canada jay, Canada jay. at 1A took short run up road (old highway) and then returned to highway 1. at 970.4. at this point photo 831016-5 of Nector formation (Precambrian 600 million years old) of scale-blocklike structure. Steller's jay, 971.0 photo of Aspen-Grove type mt. (Lake Louise Canyon) no 831016-6 just as we entered Lake Louise (town outskirts) Canada jay. 974.8 parking lot at Lake Louise Hotel. Photo 831016-7 of our Barth <sup>and another</sup> and another one (18') from Mississippi. Both about same year.