

21231 E Lost Lake Road, Snohomish Co., Washington

Jan 19, 1986

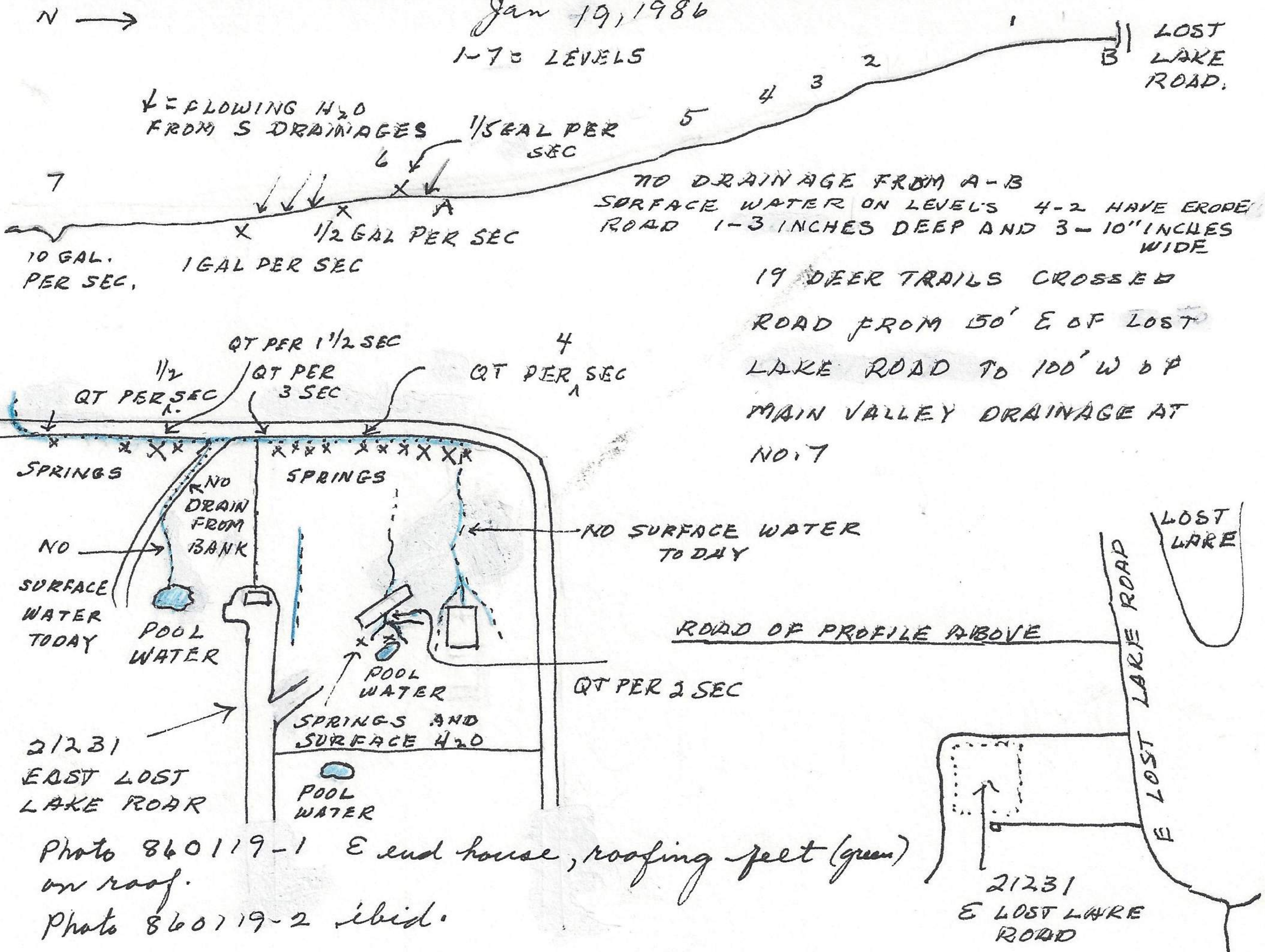
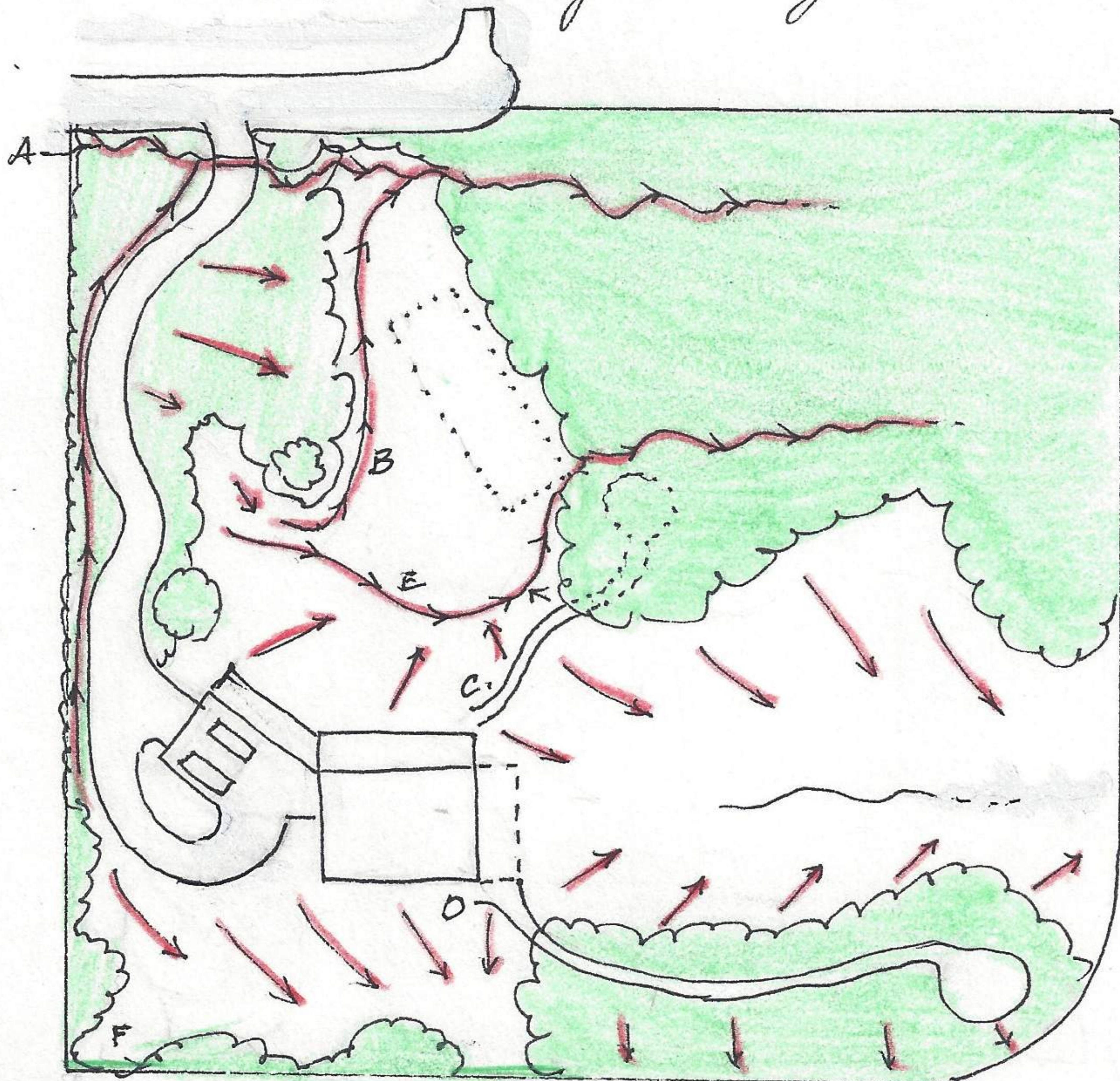

Photo 860119-1 E end house, roofing feet (green) on roof.

Photo 860119-2 ibid.

Rain last two days and nights but not this A.M.



- Control for drainage.
- A. Through drainage from property to W
 - B. Central channel for springs from pool to W on upper property.
 - C. walk ridge to divert drainage N+S.
 - D. Walk ridge to Central drainage E-W.
 - E. Central channel to by-pass meadow to N.
 - F. Provisional access for large vehicles.