

to approach feeder and while at feeder kept rear right leg out-stretch to ground behind. Any movement in kitchen window caused the deer to leave but would return.

9:15 A.M. Increased vegetation debris near shore as tide ebbs to a low -3.2 today at 12:10 P.M. Sometimes Spring Cove full of debris at high tide and following low tide clear of debris. When wind is from E or SE more debris accumulates ^{in cove} and less debris moves out.

10:20 A.M. while driving S along E side Swift Lagoon noticed 2 ad. bald eagles feeding on an adult glaucous-winged gull at the bend of the road that runs along the S side of Swift Lagoon. The gull was at the edge of the road (Port Stanley Rd.) and the eagles were pulling feathers (10 in number) from the gull. As we approached one of the eagles picked up the gull and laboriously flew S 250' along edge of conifer trees, landing with the gull on a branch 8' above ground on a Douglas fir. The second eagle followed closely. As I walked toward the tree they left the gull on the branch and flew back to bend of road and alighted in a Douglas fir above the bend. As they returned to the bend of the road, they offered a call every 4 seconds. a domestic goose in Swift Lagoon called continuously while the eagles were in the area. I recovered the gull from the branch and brought it back home for photos & measurements. Photo

860722-1 of this glaucous-winged gull. It measured: 623 mm total length, 420 mm wing, 84 mm gape, 866 grams wt, 2333 wing spread. There was no external injury except 2 sq inches of skin at back of skull where feathers had been pulled from the head, but skin not punctured.

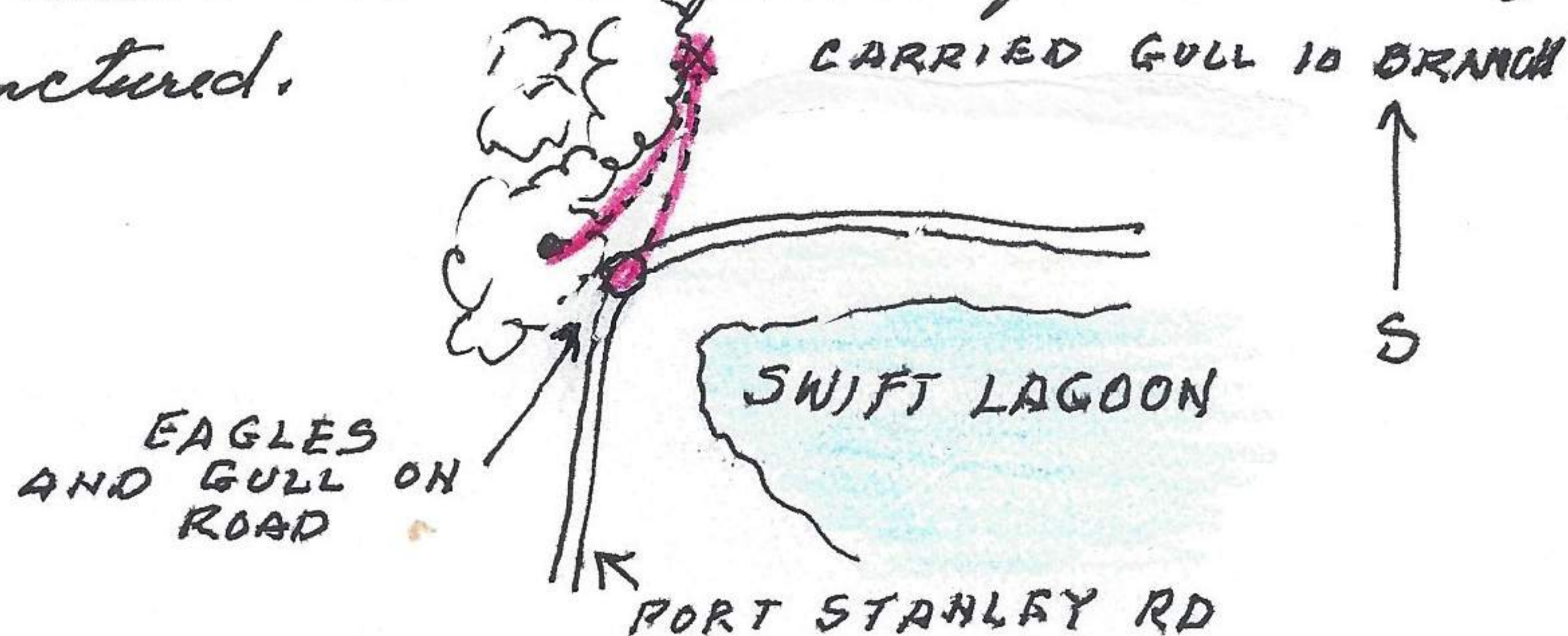
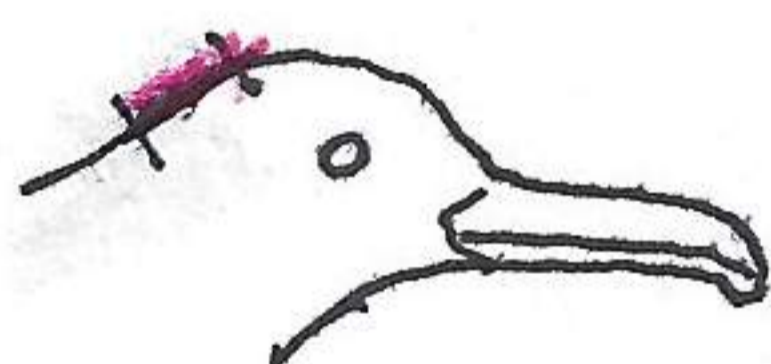

2:06 P.M. 47 Harbor seal on Leo Reef.

Drove to Joe Niederman, Rt 1, Box 2335, Shark Reef Road. He is building on 8 acres of the 50 acres he at once owned. He sold to a chemist from Switzerland who came to Univ. Wash marine Laboratories for research. The property is the point S of Shark Reef. 6 Calif. sea lions rested on rocks of Mummy Island.

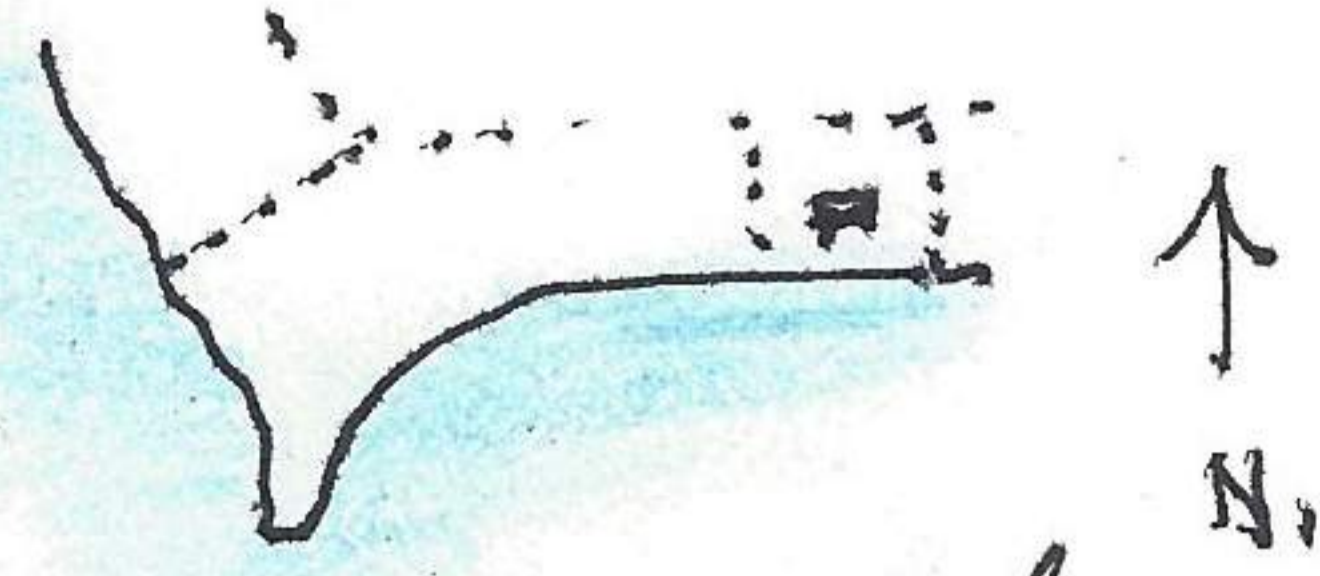

8:16 P.M. Sorex vagrans, wandering shrew, active at deer feeder: base of cliff, NW side Bee House. It ran from one rock to another and moving all the time. Came to feeder (corn at base) and each time picked up