

may 27, 1989

Overcast, rain last night.

5:00 A.M North Lopez Sound absolutely quiet and trees of Blakely a perfect reflection. no activity of birds, fish or mammals.

5:45 A.M 1 harbor seal and 3 glaucous-winged gulls active.

6:00 A.M Glaucous-winged gulls increased to 7, no other kinds of birds.

7:00 A.M Last half hour water surfaced ruffled by slight breeze but bird numbers same.

♀ mule deer 28" high at shoulders, with new golden brown hair in irregular patches in areas of hair that had been plucked by the deer. This irregular shedding and replacement of hair has not be observed in previous 2 years. Only 2 out of 14 mule deer have new, complete summer pelage.

Eastern gray squirrel with ear cut across at feeder.

Dark-eyed junco adults (2), feeding 2 young.

First time this season (3) brown-headed Cowbirds at feeder

9:10 A.M. No harbor seals on Leo Reef, at least up to now.

made trip from marina to Bee House via log trail to road beyond Simmons and thence S to Bee House.

2 fresh deer beds on edge of bench above Shoal Bay marina.

where old logging road meets road a Douglas fir cut recently (44" diameter)

This tree could be dated as to when it was cut by inspection of annulae. The pileated woodpecker had worked on the

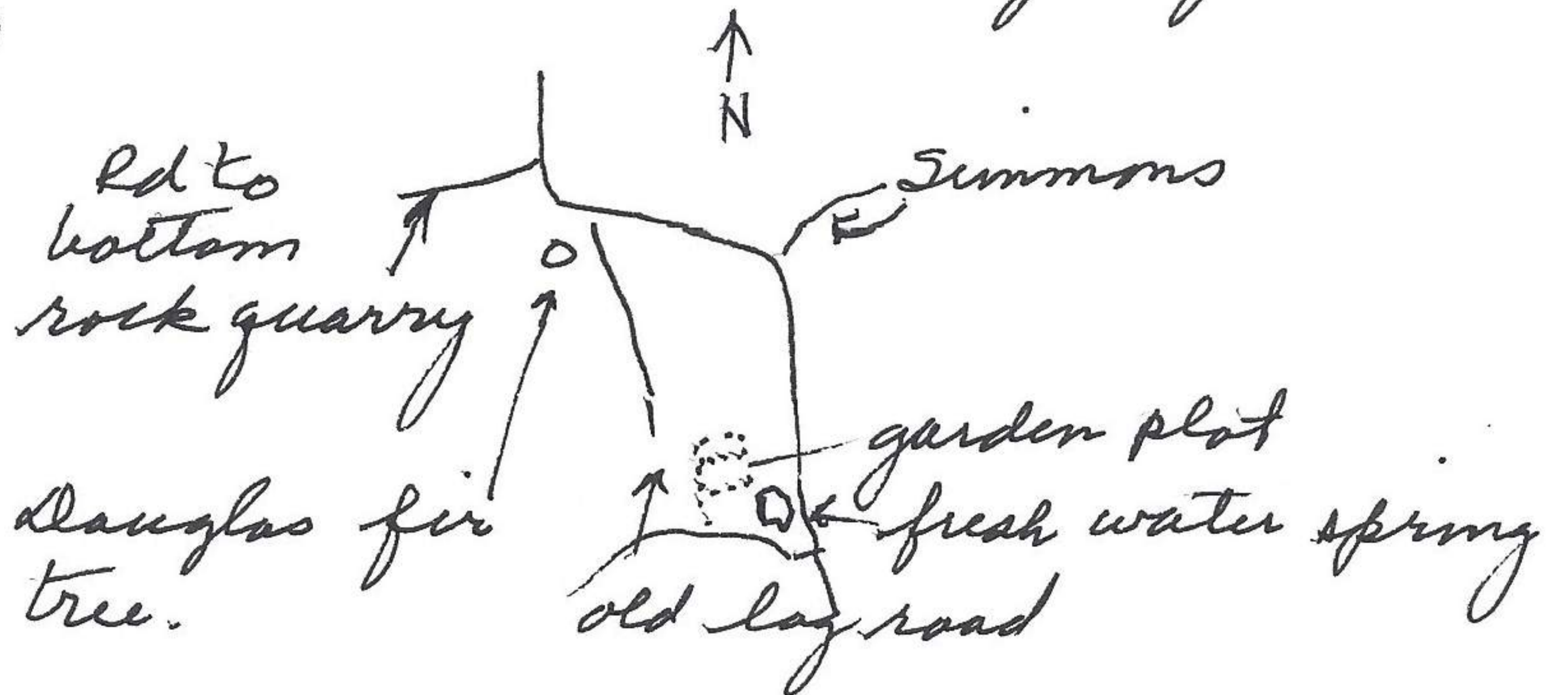

cut surface. An eastern gray squirrel was at the fresh water spring. This pond had been gutted recently. Green duckweed around edges of pond which measures approx 25'x50'.

single eye line, ♂ mule deer

♂ mule deer, antlers 6 1/2" high

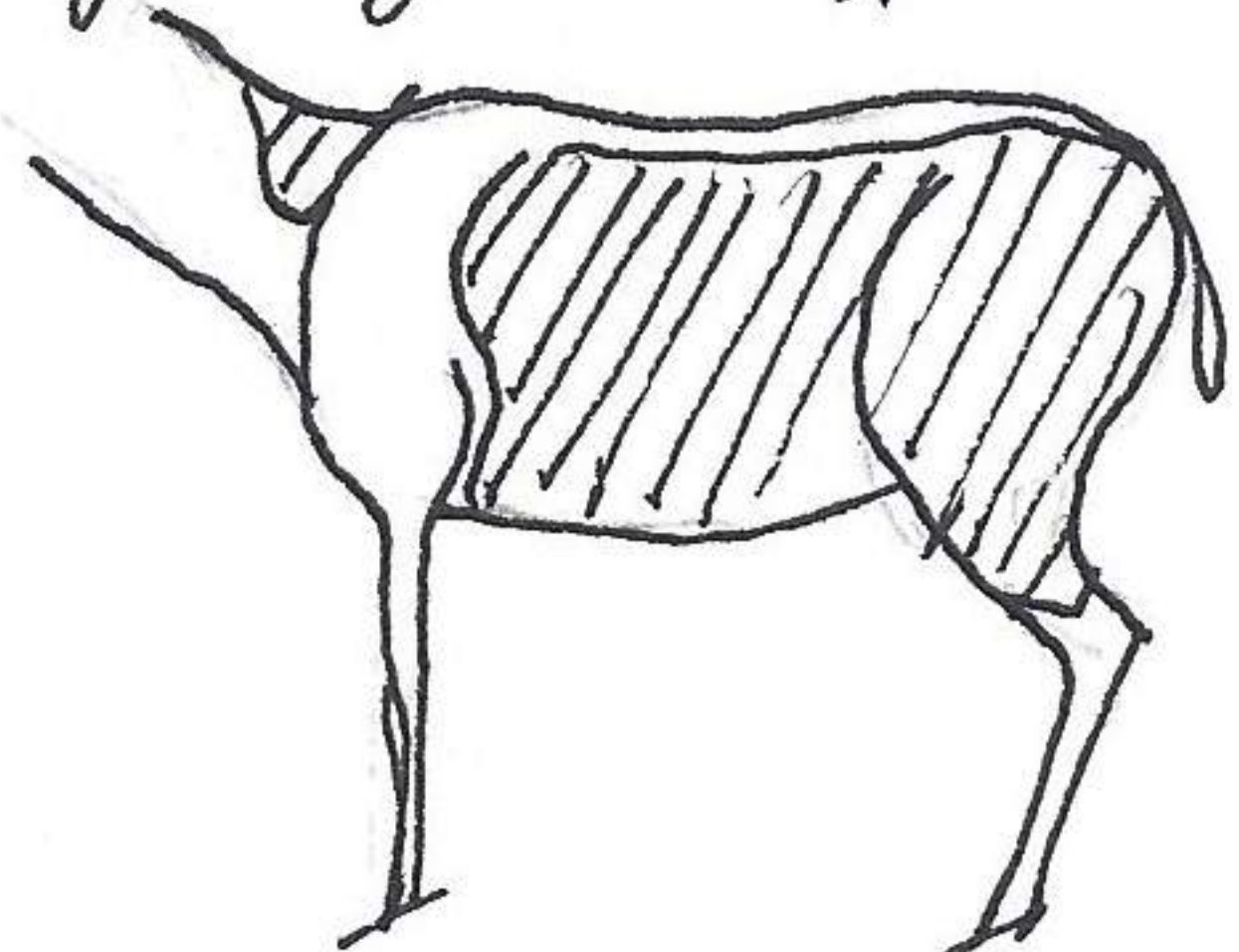

33" high at shoulders

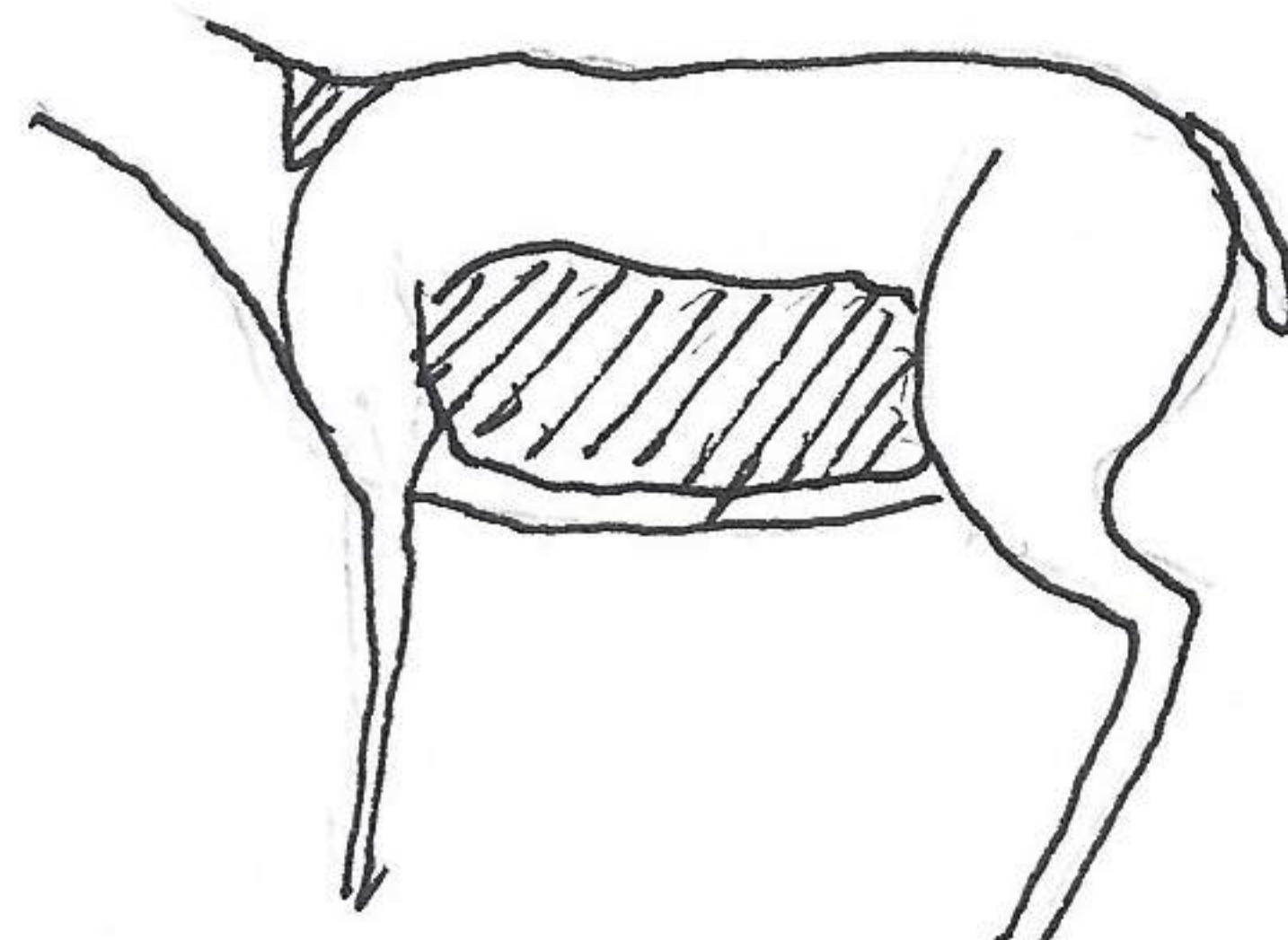

32 1/2" high at shoulders