

One mass of 48 ochre sea stars (orange and purple in equal number) in first set of 156 were compacted in an area of approx. $1\frac{1}{2}' \times 2'$. A second large mass of 72 stars (orange & purple mixed) in cliff area of 167 stars occupied an area of $2' \times 2'$.

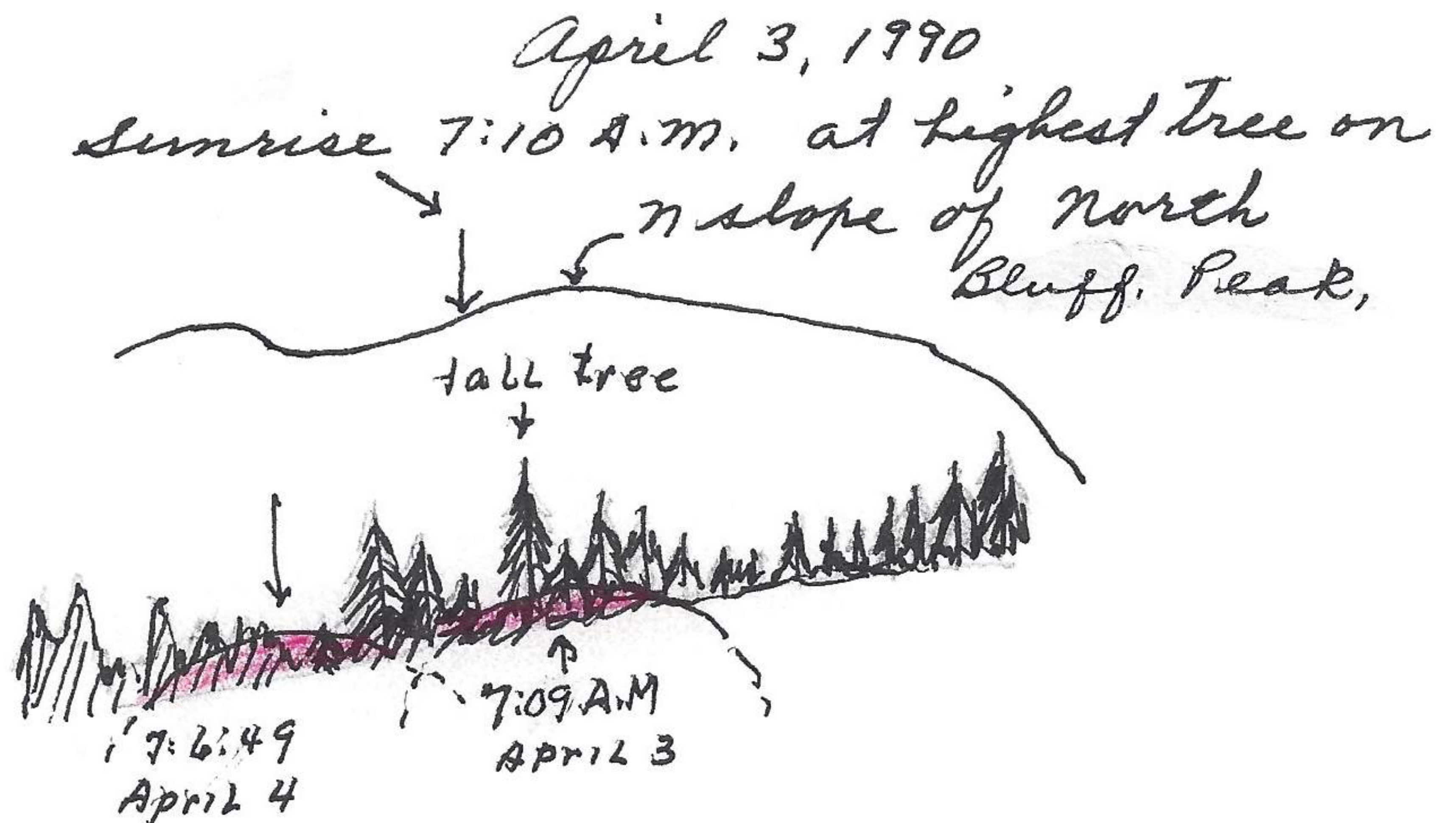

First brownish medium size butterfly this season. Band-tailed pigeon last 4 days but only a single individual.

April 4, 1990

Sunrise 7:06:49 AM, see above.

3 bald eagles flew S past Bee House before sunrise, one to Licken Point and the other 2 to Surf Bay.

April 5, 1990

mule deer measurements: ♀ young of last year 25" high at shoulders, ♀ adult 30", ♀ adult 29".

marcia simpson reports of eagle nest: Eggs hatched march 25, 1990 and young are 2 weeks old. Observation based on activity of adult at nest. The young are now on rim of nest. She has never observed a bald eagle catch a ^{live} fish from water. The eagle feeds along shore and in open fields.

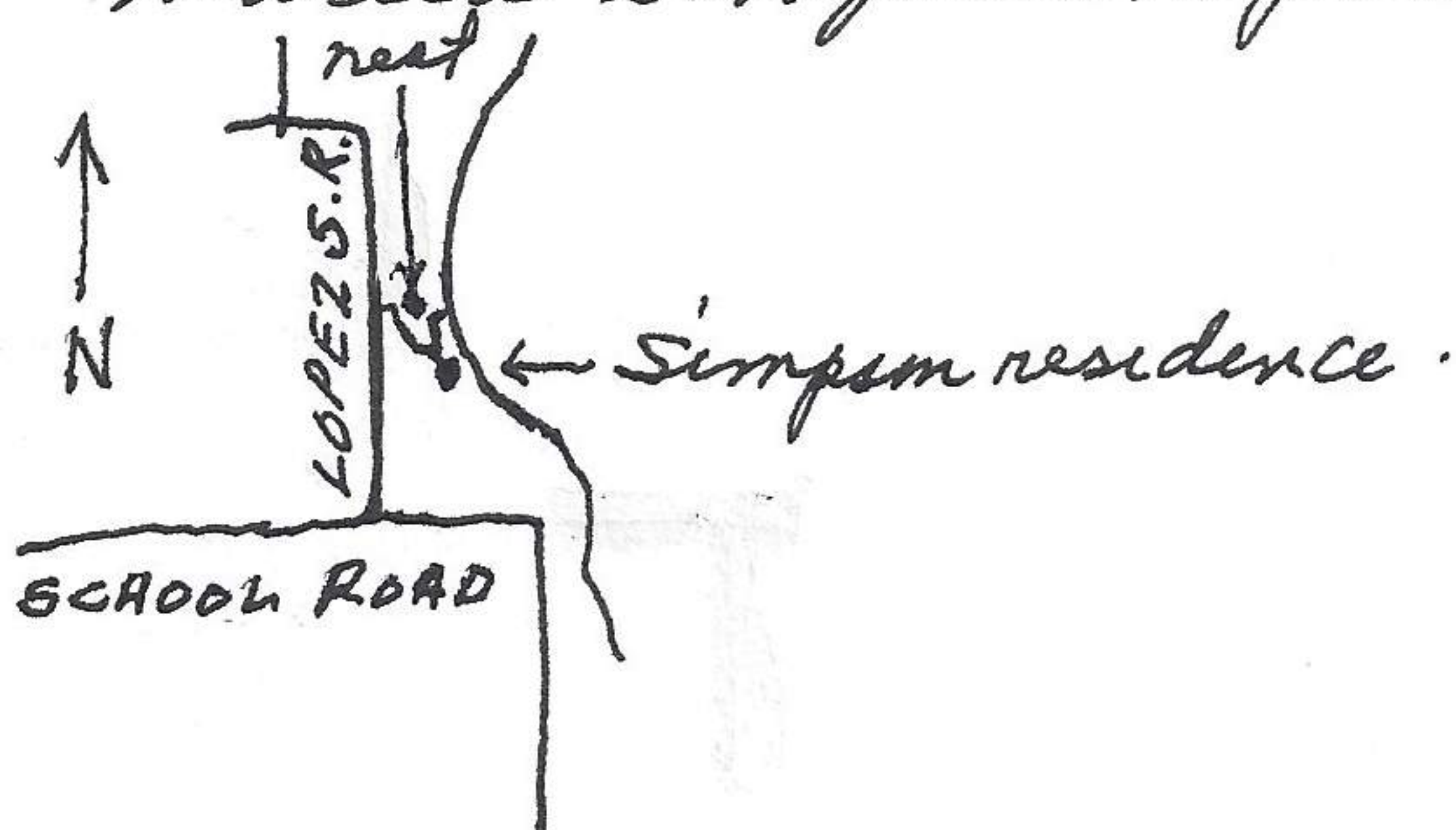

a bald eagle landed on a tree 40' from nest and remained for $\frac{1}{2}$ hour.