

HALLS

The entrance hall is a revealing glimpse into the home. Use light to show the area and yourself to advantage, and to help you impart graciousness and hospitality.

WHAT TO USE

Select fixtures in accordance with the size of the area and style of furnishings. Use these to keynote the style of fixtures to be seen in adjoining rooms. (Types with closed tops are needed if bulbs are visible from stairs).

FOR ENTRANCE HALL—Ceiling Fixture: three sockets, 40w each. 12" min. dia. shielding; or 4" dia. shielding of each bulb; Or 100w, 14" dia. shield.

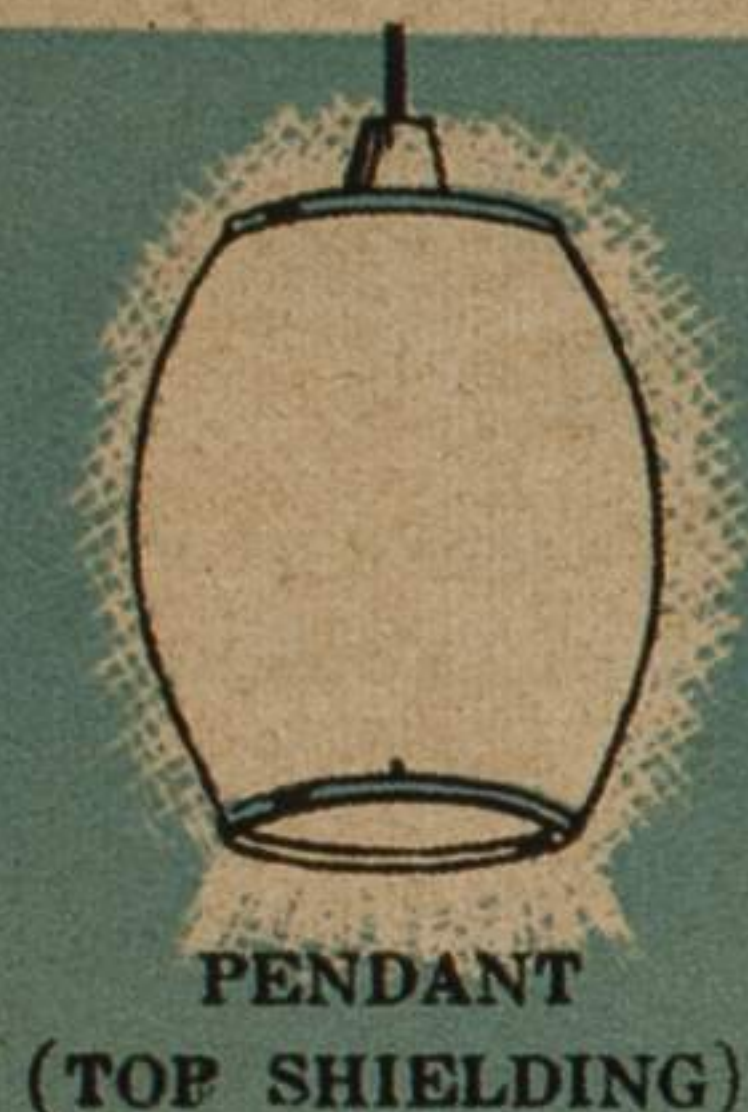

PENDANT
(TOP SHIELDING)

Or, three 50w GA bulbs, unshielded.



CLOSE-TO-CEILING
(OPEN PAN
OR CLOSED BOWL)

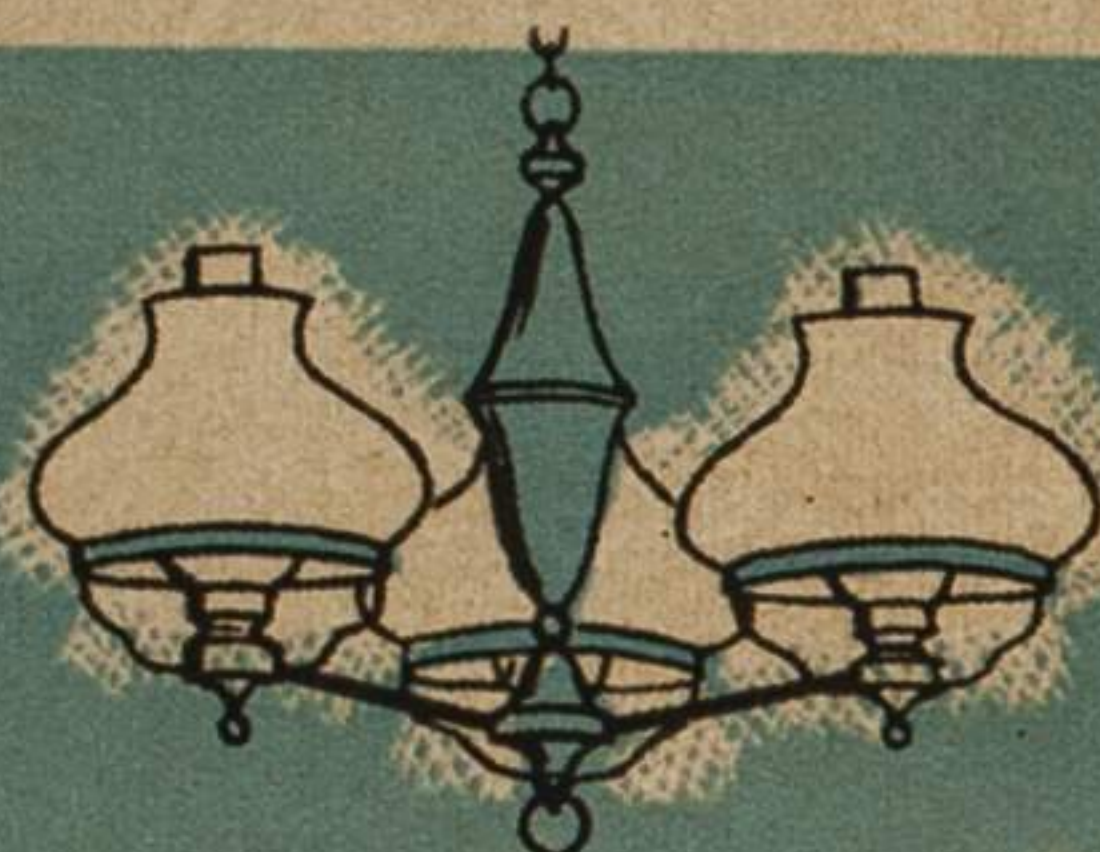

ABOVE:
MULTIPLE SHIELDING
BELOW:
OPAQUE SIDE SHIELDING

VESTIBULE—Ceiling Fixture: one socket, 60w - 8" min. dia. shield

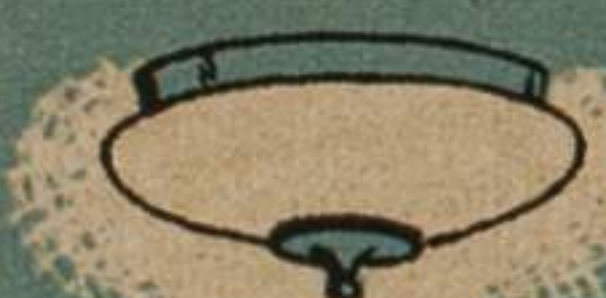

Or, two 50w GA bulbs, unshielded

Or, Wall-Bracket; shielded Incandescent, one 60w,

Or, Fluorescent: two 18"-15w DeLuxe Warm White tubes

PASSAGEWAY—repeat Vestibule Recipe at 8' centers

SERVICE HALLS—styles related to kitchen.

INCANDESCENT: one 75w, 8" dia., shielded,
or one 100w or two 50w GA bulbs.

FLUORESCENT: DeLuxe Warm White, one
32w circline; or two 18"-15w tubes.

CLOSETS—(over 9' sq. or 2' deep) 60w min.
Walk-in areas usually 100w min.

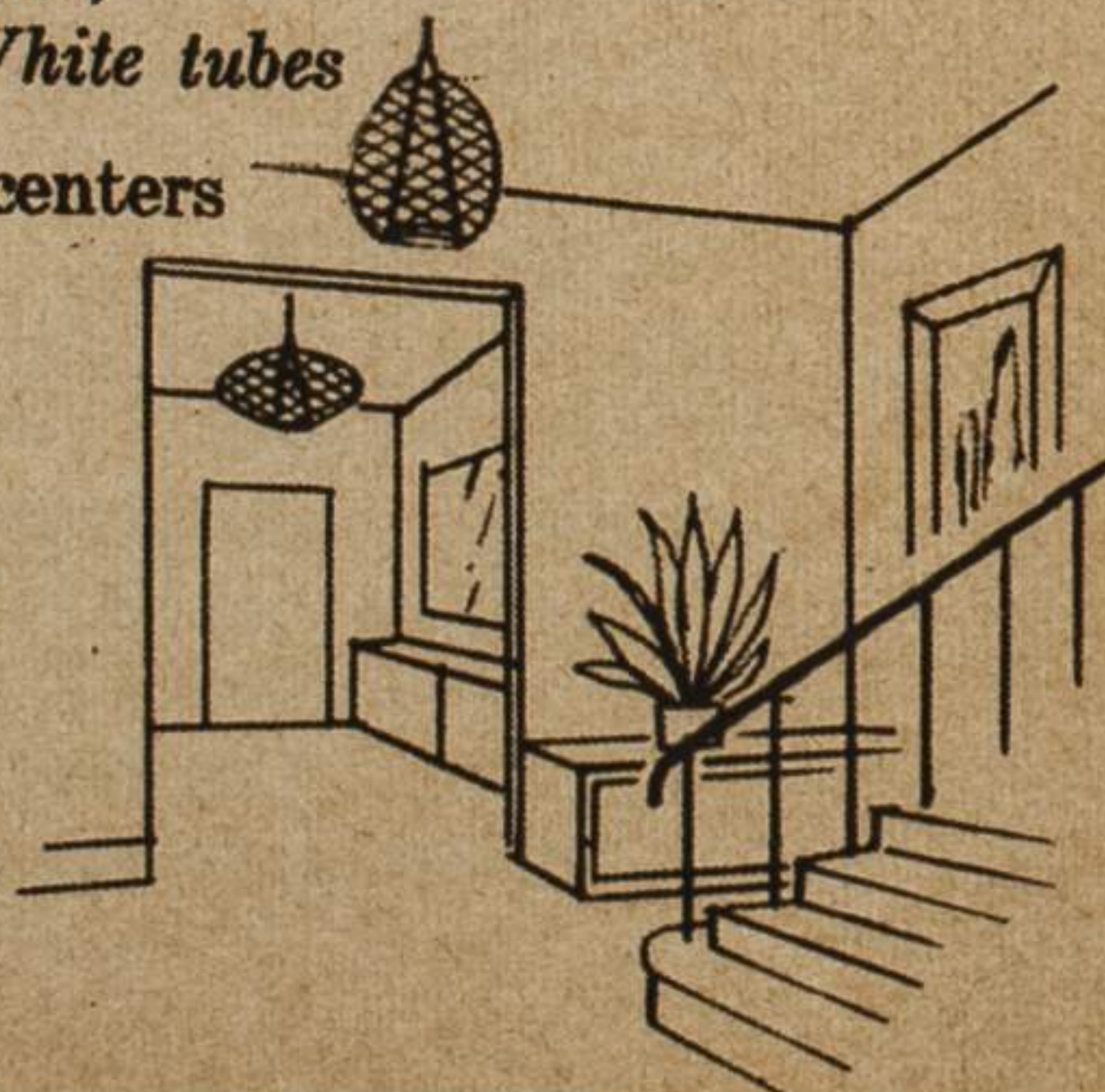

ENTRANCES

A light-conditioned entrance expresses cheerfulness and welcome. There is convenience and safety for yourself and others.

WHAT TO USE

A Group of Fixtures selected and positioned in accordance with your types of entrances; also the length and location of steps, walks and driveway. A coordinated group related to the style of the house adds to a harmonious appearance; suggests care and integrity in design and construction.



A.

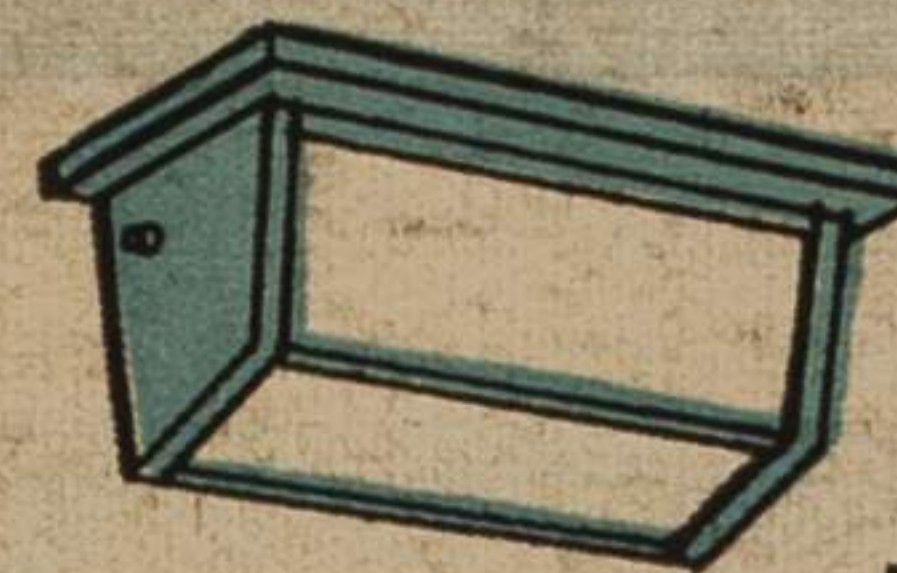

B.

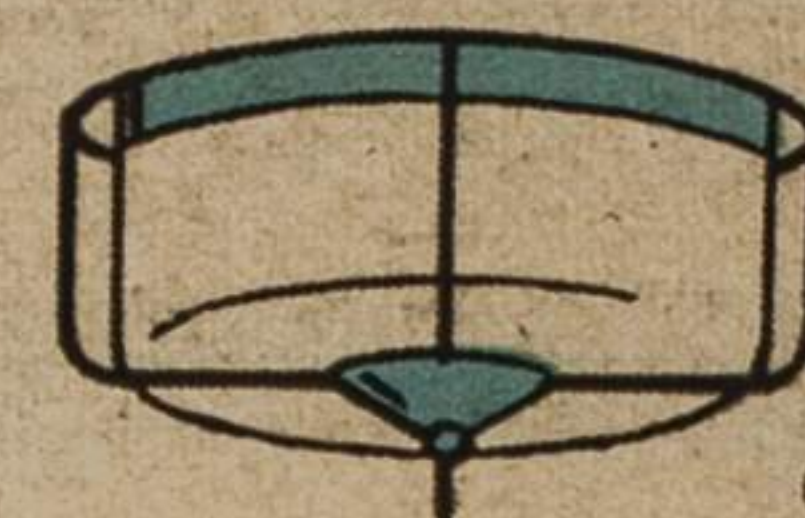

C.



D.

A. Wall-Bracket

On each side of main entrance.
On lock side of other entrances.
66" above standing level.
Min. 6" dia. shielding. 40w each.

B. Overhead Wall-Bracket

Over garage or house entrances.
One 60w or two 40w each.

C. Ceiling Fixture

Center on porch or breezeway ceiling. Min. 10" dia. shielding
Two sockets, 40w each.

Small Portico:

Min. 6" dia. shielding. One 40w

D. Post Lantern

One 60w min.

Avoid clear glass, or bulbs will glare into eyes. Opaque top, and open or glass bottom, directs light downward to foot level.

YARD LIGHTING

Projector lamps conveniently and inexpensively light driveways and large areas. Use 150w flood type in weather-resistant holder. Mount high on house, under eaves, or on trees or poles.

GARAGE LIGHTING.

In 1-car garage use 100w SOFT-WHITE bulbs in two sockets. Locate on ceiling at each side of car spaced approximately midway in length of garage. This recipe provides safer, surer seeing for getting in and out of cars. In 2-car garage add a third ceiling socket and 100w SOFT-WHITE bulb, in line with the other two sockets. A fourth outlet may be on wall between garage doors.

LIGHT FOR LIVING—OUTDOORS

Use the Outdoor Lighting Recipes to add more space to your home. They make possible more and better use of your investment in land and outdoor furnishings.

(Booklet 1.5-5229R)

