

Typical hurdle used
as lane markers following
the 16' wall
and
hedge
hop.

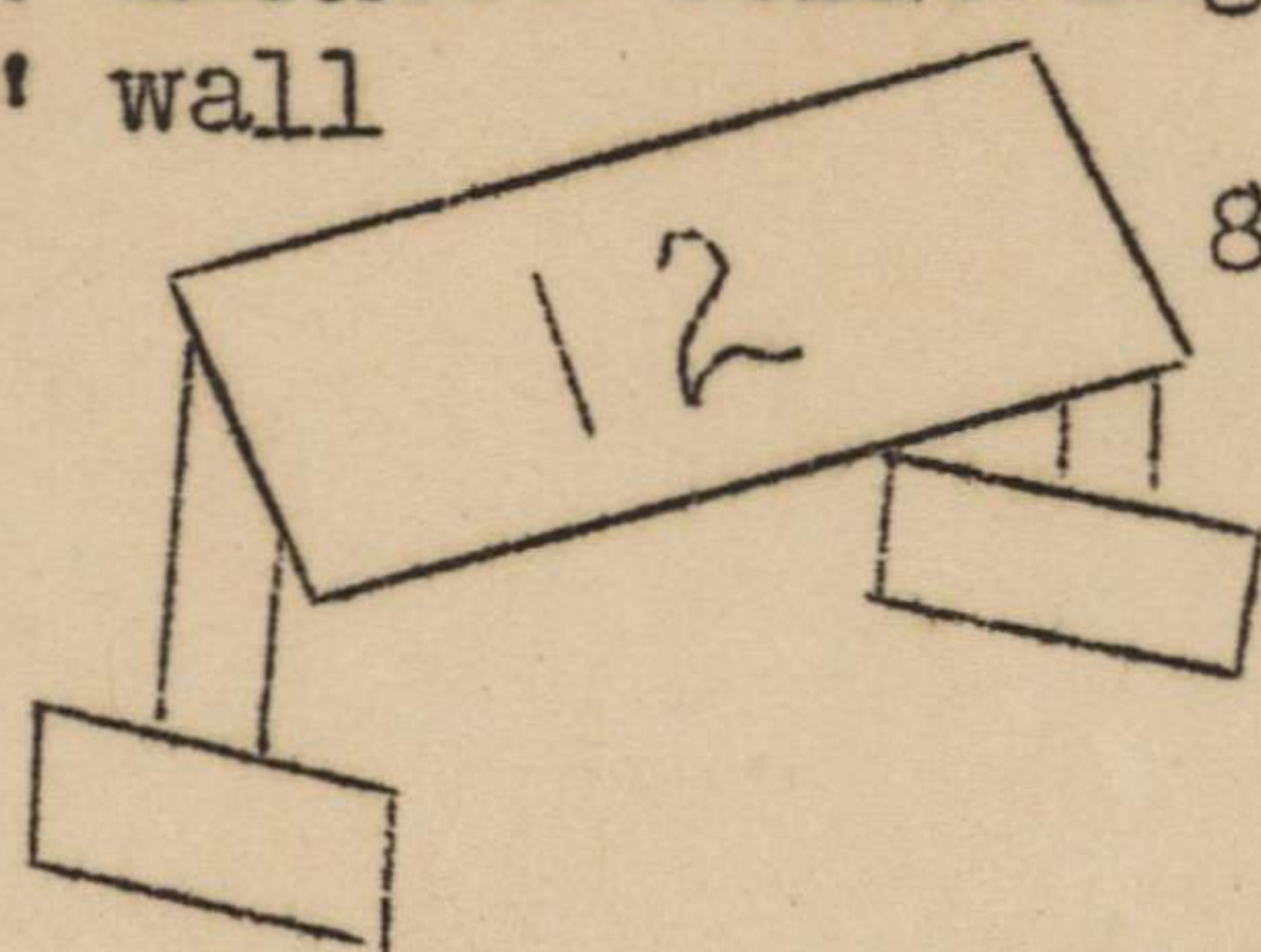

8" or 10" high

live hedge privet

Hedge Hop
24" high
36" wide

Small Ditches. To make lanes
permanent will keep lime in
lanes but not necessary if
white gravel is used.

Curve 66 yds.

Wall Scale
7' high

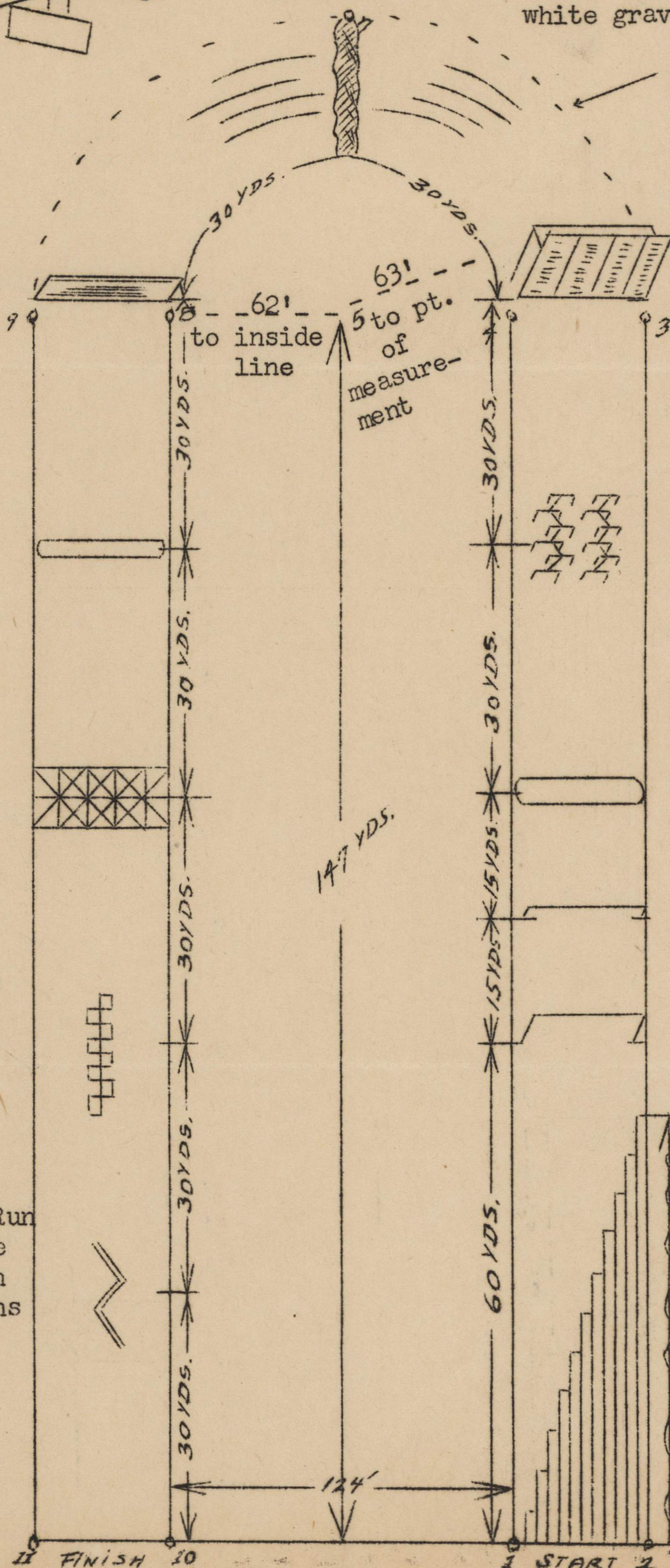

Wall 16' high
Ropes and ladders

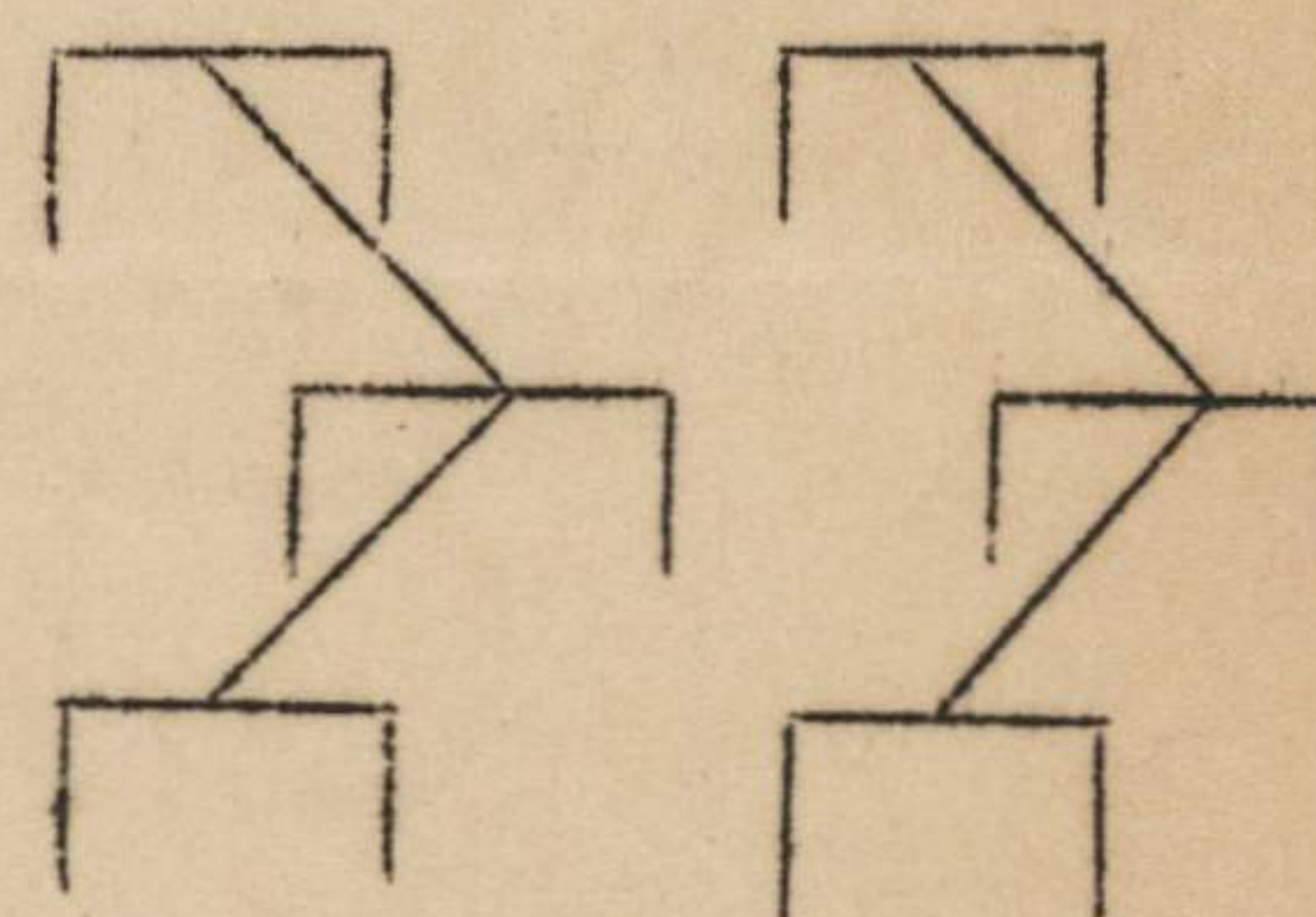

6 zig zig hurdles
24" high, 24" wide
and 6' apart

Broad Jump
6' wide

Broad Jump 8'
(Slope far edge
to bottom)

Wire Tunnel
20' long
40" high

Hurdle 30" high

8 Boxes
24" x 24"
8" high

Knee
Lift

Fence Vault
5' high

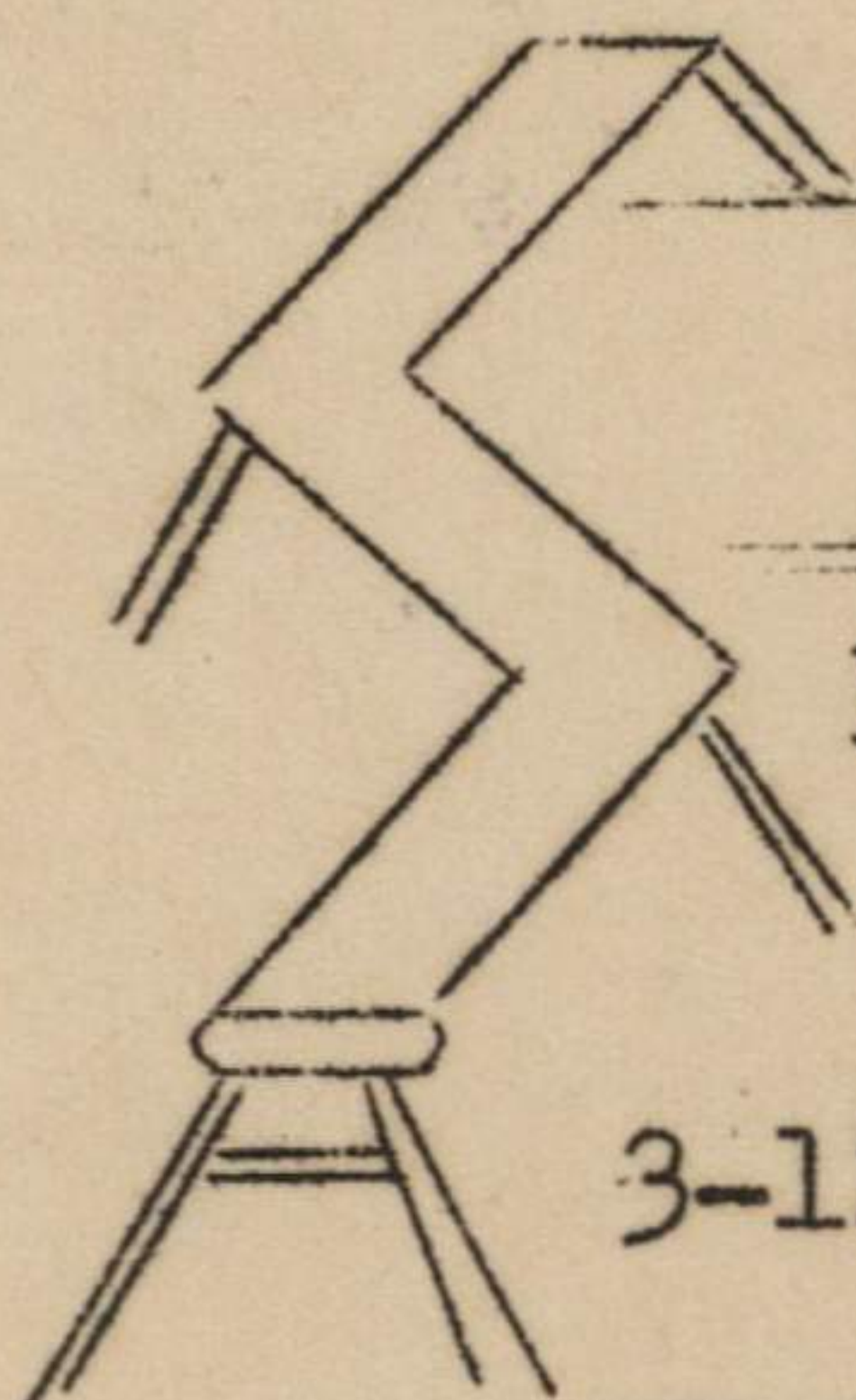

Balance Run
1' wide
2' high
3-12' sections

2" x 6"

Stagger: Lane 2
over Lane 1, 12'
6.8"
Lanes 3,4,5,6,7,8,
9,10,11,12--over
next lane to inside
12'6.8".

All lanes measured
12" from lane line.

Numbers 1-11 indicates
stakes to be set.

12-4' lanes